



Arkansas Secretary of State

Mark Martin Arkansas Secretary of State, 500 Woodlane Ave, Little Rock, AR 72201-1094

Municipal Boundary Change Checklist

County: Washington City/Town: West Fork

City Ordinance/Resolution No: 2016-07 Date approved: 08/09/2016

County Court Case No: CC 2016-5 Date Order Filed: 08/04/2016

Type: Annexation by Petition of all Landowners A.C.A §14-40-609

Date Change Effective: _____ Emergency clause: Yes No

For Circuit Court Challenge: Date Order Filed: _____ Upheld Overturned Other (attach explanation)

Initiating party:

All Landowners Majority Landowners Municipal Governing Body State Other _____

Supporting Documentation attached (check all that apply):

- File marked copy of City Ordinance/Resolution (not required for A.C.A § 14-40-1801)
- File marked copy of County Court Order (not required for A.C.A. § 14-40-501)
- Proof of Publication for all Legal Notices (Hearing, Election, City Ordinance/Resolution)
- Copy of Arkansas GIS approved printed map and certification letter
- File marked copy of Petition Part or File marked copy of the certified special election results (if applicable)
- File marked copy of Complaint and final Circuit Court Order (Court Challenge only)

Municipal Contact:

Name: Ms. Marsha Hungate Title: West Fork City Clerk

Street Address: P.O. Box 339

City: West Fork St: AR Zip code: 72774

City/County Official:

Signature: Hon. Becky Lewallen Title: Washington County Clerk

Date: _____

Complete one form for each ordinance/resolution and attach it as a cover page to the supporting document set. Submit the documents to Arkansas Secretary of State, Atten: Municipal Boundary Filing, 500 Woodlane Ave, Little Rock, AR 72201-1094

Office of the Arkansas Secretary of State use only

Received by: Cynthia Fisher

FILED

FEB 15 2017

Arkansas Secretary of State



WASHINGTON COUNTY

STATE OF ARKANSAS

Washington County Courthouse
280 North College Avenue, Suite 300
Fayetteville, Arkansas 72701
Telephone: (479) 444-1711
Fax: (479) 444-1894

BECKY LEWALLEN
County And Probate Clerk

December 27, 2016

To Whom it may Concern:

You will find enclosed 4 Annexations. One to the City of Springdale by Ordinance, and four to the city of West Fork by Ordinance. If you have any further questions please don't hesitate to call.

Thanks,

Jennifer Sharpshoe



BECKY LEWALLEN
County And Probate Clerk

WASHINGTON COUNTY
STATE OF ARKANSAS
Washington County Courthouse
280 North College Avenue, Suite 300
Fayetteville, Arkansas 72701
Telephone: (479) 444-1711
Fax: (479) 444-1894

CERTIFICATE OF COUNTY AND PROBATE COURT

THE STATE OF ARKANSAS,
COUNTY OF WASHINGTON.

I, Becky Lewallen, County and Probate Clerk within and for the County and State aforesaid, do hereby certify that the foregoing is a true and correct copy of 4 Annexations as they appear of Record File Thereof.

IN WITNESS WHEREOF, I have hereunto set my hand and affixed my official seal on

This 27th day of December, 2016.

Becky Lewallen

County Clerk

By: *Jennifer Shoemaker*
Deputy County Clerk



RESOLUTION NO. 2016-07

2016 AUG 10 AM 11:53
FILED
DEPUTY CLERK
CO. & PROBATE CLERK
WASHINGTON CO. ARK.

ACCEPTING THE ANNEXATION OF CERTAIN TERRITORY; AND APPROVING THE SCHEDULE OF SERVICES TO BE PROVIDED TO SAID AREA

WHEREAS, a petition was filed, pursuant to A.C.A. 14-40-609, for the annexation of certain territory into the City of West Fork, Arkansas; and

WHEREAS, the Washington County Assessor and the Washington County Clerk have (A) Verified the identity of the petitioner(s); (B) Verified that there are no property owners included in the petition that do not wish to have their property annexed; (C) Verified that the property or properties are contiguous with the city; (D) Verified that no enclaves will be created if the petition is accepted by the city; and presented the petition and their respective verifications to the Washington County Judge; and

WHEREAS, the County Judge has (A) Reviewed the petition and verifications for completeness and accuracy; (B) Determined that no enclaves will be created by the annexation; (C) Confirmed that the petition contains a schedule of services; and (D) Issued an order articulating these findings, and forwarded the petition and order to the contiguous City of West Fork for consideration; and

WHEREAS, said territory is deemed suitable for incorporation because it represents the actual growth of the city beyond its legal boundary; and

WHEREAS, it is the desire of the City Council that said territory be annexed.

NOW, THEREFORE, BE IT RESOLVED BY THE CITY COUNCIL OF THE CITY OF WEST FORK, ARKANSAS:

SECTION 1. That the following described territory, contiguous to the City of West Fork, be and the same is hereby accepted as part of, and annexed to and made a part of the City of West Fork, Arkansas to wit:

All of the following described property not already in the City of West Fork:
A part of the SE ¼ of the SE ¼ and a part of the SW ¼ of the SE ¼ in Section 5 and a part of the NW ¼ of the NE ¼ and a part of the NE ¼ of the NE ¼ in Section 8, all in the T-14-N, R-30-W in Washington County, Arkansas and being more particularly described as follows: Beginning at a point 511.50 feet North and S72°00'00"W 1304.84 feet from the SE corner of said SE ¼; thence S72°00'00"W 382.86 feet; thence N89°38'31"E 21.38 feet; thence S08°00'00"W 361.59 feet; thence N78°36'54"E 430.75 feet; thence N04°14'00"W 392.29 feet to the point of beginning, containing 3.30 acres more or less, same being Washington County Parcel 001-03231-000.

SECTION 2. That the following schedule of services shall be extended to the area by the City of West Fork within the statutorily required three (3) years after the date the

FILED
FEB 15 2017
Arkansas
Secretary of State

annexation becomes final, as follows: Police Protection; Fire Protection; Public Street Maintenance; Sanitation Service; and Zoning and Code Enforcement.

PASSED AND APPROVED THIS 9 DAY OF August, 2016.

Don Rollins
Mayor

Attest: Masha Fungate
City Clerk

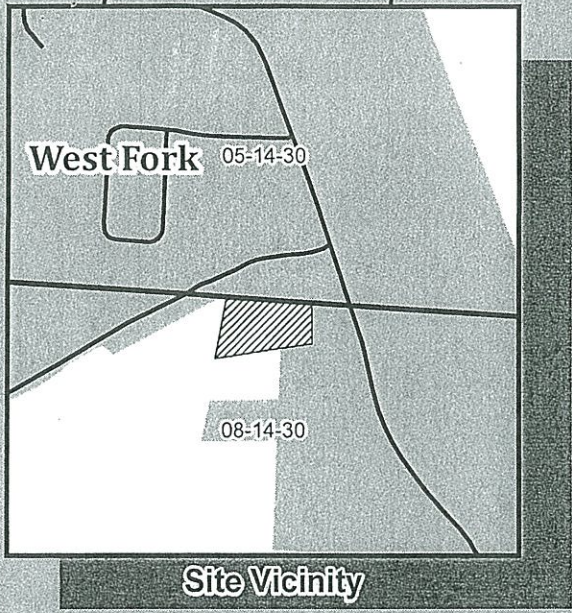

EXHIBIT A



**West Fork Annexation
Collins, John R. & Myra Levan
Parcel 001-03231-000**

West Fork



MCKNIGHT AVE

**Area to be
Annexed**

BULLARD RD

Map Features

- Roads
- Section Lines
- ▨ Annexation Area
- West Fork City Limits



IN THE WASHINGTON COUNTY COURT

IN THE MATTER OF ANNEXING TO THE CITY OF WEST FORK, ARKANSAS, CERTAIN TERRITORY CONTIGUOUS TO THE CITY OF WEST FORK, ARKANSAS

CLERK OF COURT
WASHINGTON COUNTY
CO. & PROBATE CLERK

2016 AUG -4 AM 9:13

FILED

PETITIONER(S): Myra L. & John R. Collins

cc Case No. 2016- 5

ORDER AUTHORIZING ANNEXATION PURSUANT TO A.C.A. 14-40-609

I, Marilyn Edwards, County Judge of Washington County, Arkansas, having reviewed the attached petition for annexation and verification of petition, pertaining to annexation of the following lands to the City of West Fork, Arkansas:

All of the following described property not already in the City of West Fork:
A part of the SE ¼ of the SE ¼ and a part of the SW ¼ of the SE ¼ in Section 5 and a part of the NW ¼ of the NE ¼ and a part of the NE ¼ of the NE ¼ in Section 8, all in the T-14-N, R-30-W in Washington County, Arkansas and being more particularly described as follows: Beginning at a point 511.50 feet North and S72°00'00"W 1304.84 feet from the SE corner of said SE ¼; thence S72°00'00"W 382.86 feet; thence N89°38'31"E 21.38 feet; thence S08°00'00"W 361.59 feet; thence N78°36'54"E 430.75 feet; thence N04°14'00"W 392.29 feet to the point of beginning, containing 3.30 acres more or less, same being Washington County Parcel 001-03231-000;

hereby find:

- (1) That the petition and verification are complete and accurate;
- (2) That no enclaves will be created by the proposed annexation: and
- (3) That the petition contains a schedule of services.

The County Clerk is directed to forward a copy of this Order and the related Petition to the City Clerk of the City of West Fork, Arkansas.

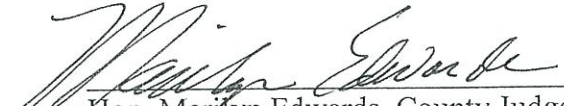

Hon. Marilyn Edwards, County Judge

8-4-16
Date

APPROVED AS TO FORM

AUG 04 2016

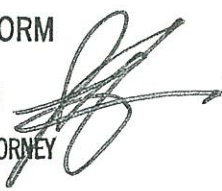
WASHINGTON COUNTY ATTORNEY



T3-133

FILED

FEB 15 2017

Arkansas
Secretary of State



ARKANSAS
GIS OFFICE

August 2, 2016

John & Myra Collins
727 McKnight St
West Fork, AR 72774

RE: City of West Fork Annexation Coordination Requirement

Mr. & Mrs. Collins,

Thank you for coordinating with our office as you seek to annex property into the City of West Fork, AR. This letter represents confirmation that you have properly coordinated with our office (Arkansas GIS Office) as specified in § 14-40-101 (Act 914 of 2015) of the 90th General Assembly.

Our office will wait completion of any additional steps necessary for the proposed boundary change, which normally comes from the Arkansas Secretary of State Elections Division after any appropriate filing by your County Clerk.

Thank you,

Shelby D Johnson, State Geographic Information Officer
/sdj

Attachments:

GIS Office Map of Proposed Annexation
Secretary of State Municipal Change Checklist

FILED
FEB 15 2017
Arkansas
Secretary of State

City: West Fork
Mayor: Pending

Proposed Annex: City of West Fork
August 2016

Arkansas Code 14-40-101.

Before an entity undertakes an annexation, consolidation, or detachment, proceeding under this chapter, the entity shall coordinate with the Arkansas Geographic Information Systems Office for preparation of legal descriptions and digital mapping for the relevant annexation, consolidation, and detachment areas.

The map contained herein, in evidence, the entity has met requirements of Act 914 of 2015

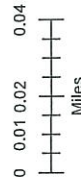
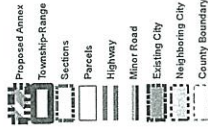

ARKANSAS
GIS OFFICE

FILED
FEB 15 2017
Arkansas
Secretary of State