

BAS Correction Portion of Ord 650-01: City of Walnut Ridge
 *for Census only - was already in state map

City: Walnut Ridge
 Mayor: Charles Snapp

Arkansas Code 14-40-101.

Before an entity undertakes an annexation, consolidation, or detachment proceeding under this chapter, the entity shall coordinate with the Arkansas Geographic Information Systems Office for preparation of legal descriptions and digital mapping for the relevant annexation, consolidation, and detachment areas.

The map contained herein, is evidence, the entity has met requirements of Act 914 of 2015

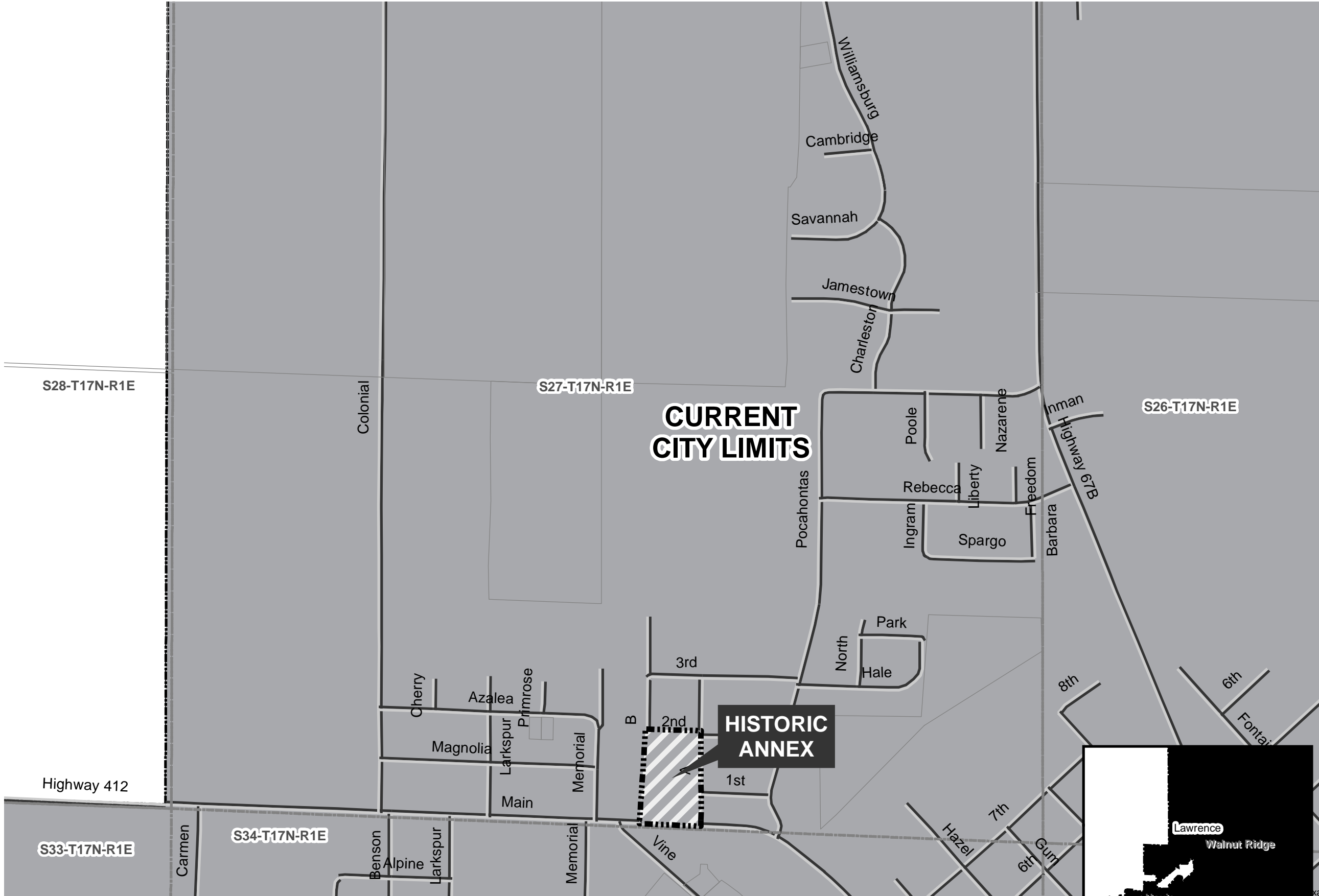

- Proposed Annex
- Sections
- Parcels
- Minor Road
- Existing City
- Neighboring City
- County Boundary

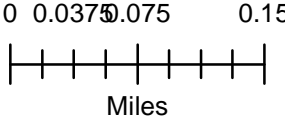

ARKANSAS GIS OFFICE



State of Arkansas SECRETARY OF STATE

Sharon Priest
SECRETARY OF STATE

February 23, 2001

The Honorable Billie Gail Dunlap
Lawrence County Clerk
Post Office Box 526
Walnut Ridge, AR 72476

Dear Ms. Dunlap:

The Following Information has been recorded and filed in the Office of the Secretary of State:

Date: 02/20/2001 County: Lawrence City: Walnut Ridge

Annexation:	Ordinance No. - 650-01
	Co. Order No.
	Plat - X--detachment
	Election -
	Island -
Incorporation:	Ordinance No. -
	Co. Order No. -
	Plat -
	Election -
Census Information	-
1st Class City	-
2nd Class City	-
Incorporated Town	-

I have forwarded this information to the Arkansas Municipal League. If you have any further questions please do not hesitate to contact me at 1-800-482-1127 or 682-3451.

Sincerely,

Tena Arnold
Election Services Representative

ORDINANCE NO. 650-01

AN ORDINANCE DETACHING PARTS OF SECTION ONE (1), TWELVE (12), AND THIRTEEN (13), TOWNSHIP SIXTEEN (16) NORTH, RANGE ONE (1) EAST FROM THE CITY LIMITS OF WALNUT RIDGE, ARKANSAS.

BE IT ORDAINED BY THE WALNUT RIDGE CITY COUNCIL AS FOLLOWS:

Section 1. That all landowners located in Section One (1); and all of Section Twelve (12) North and East of the railroad; and Section Thirteen (13) North and East of the railroad, all in Township Sixteen (16) North, Range One (1) East, Lawrence County, Arkansas, have filed a proper affidavit and petition requesting that their properties in Sections One (1), Twelve (12) and Thirteen (13), Township Sixteen (16) North, Range One (1) East which have recently been annexed to the City of Walnut Ridge, Arkansas be detached.

Section 2. That a plat of the area reflecting the land which is to be detached is attached to this ordinance and incorporated herein and made a part hereof.

Section 3. The City Council of Walnut Ridge does hereby approve the request of all landowners described in Section 1 hereof and does hereby order that their property described in Section 1 hereof be detached from the City of Walnut Ridge, Arkansas and henceforth said property is no longer a part of the City of Walnut Ridge, Arkansas.

Section 4. The City Clerk is hereby order to certify a copy of this ordinance and the plat along with a copy of the qualifying affidavit to the County Clerk who is hereby requested to forward the documents to the Secretary of the State of Arkansas. The County Clerk is also requested to forward one copy of the plat and one copy of this ordinance to the director of the tax division of the Arkansas Public Service Commission.

Section 5. These proceedings have been conducted and approved pursuant to Ark. Code Ann. 14-40-608.

Section 6. This Ordinance being necessary for the public health, safety and well-being of the citizens of the Town of Walnut Ridge, Arkansas, an emergency is hereby declared and this Ordinance shall take effect immediately upon passage hereof.

Dated this 13th day of February, 2001.

JR Rogan
Mayor

APPROVAL:

Carolyn Hayes
Clerk



TOWNSHIP 16N • RANGE 1E

Detached
↓



SEE PAGE 22

PETITION

We, the undersigned, do make the following statement on our oath:

1.

That our land has been annexed to the City of Walnut Ridge within the last past three years.

2.

That our land is located inside the City of Walnut Ridge along the municipal border.

3.

The undersigned desire that the annexed land be detached from the municipality.

4.

An exact copy of the plat showing the territory to be detached and a copy of the order of the County Court approving the annexation and the resolution of the City Council accepting the annexation are attached.

5.

The undersigned all individually state on their oath that the above facts are true and correct.

DATED: 2-12-2001

Zada Beckley

Subscribed and sworn to before me this 12th day of February, 2001.

Russel Schmitt
Notary Public

2-18-2004

DATED: 2-12-2001

Philip Farnsworth

Subscribed and sworn to before me this 12th day of February, 2001.

Russel Schmitt
Notary Public

2-18-2004

DATED: 2-12-01

Vivian Farnsworth

Subscribed and sworn to before me this 12th day of February, 2001.

Russel Schmitt
Notary Public

2-18-2004

DATED: 2-12-01

Ricky Durst

Subscribed and sworn to before me this 12th day of February, 2001.

Russel Schmitt
Notary Public

2-18-2004

DATED: 2-12-01

Tracy L. Estes

Subscribed and sworn to before me this 12th day of February, 2001.

Tracy L. Estes
Notary Public

TRACY L. ESTES
NOTARY PUBLIC
LAWRENCE COUNTY
My Appt. Expires 9-22-2002

Page Two

DATED: 2-12-2001

Zada McKay

Subscribed and sworn to before me this 12th day of February, 2001.

Isabel Sanchez
Notary Public

DATED: 2-12-2001

William C. Little
Ark. DL 490145330

Subscribed and sworn to before me this 12th day of Feb, 2001.

GLORIA B. JONES
Notary Public-State of FL
Comm. Exp. Jan. 12, 2005
Comm. No. CC 986708

Gloria B. Jones
Notary Public

DATED: Feb 12 2001

Valerie H. Little
Ark. DL 312129597

Subscribed and sworn to before me this 12th day of Feb, 2001.

GLORIA B. JONES
Notary Public-State of FL
Comm. Exp. Jan. 12, 2005
Comm. No. CC 986708

Gloria B. Jones
Notary Public

DATED: _____

Subscribed and sworn to before me this _____ day of _____, 2001.

Notary Public

DATED: _____

Subscribed and sworn to before me this _____ day of _____, 2001.

Notary Public

PHILLIPS COUNTY ARK. PUBLIC CLERK ATTORNEY FAX NO. 501-826-1141

Page Three

DATED: 2-12-01 Hq + L Emma [Signature]
Subscribed and sworn to before me this 12th day of February, 2001.

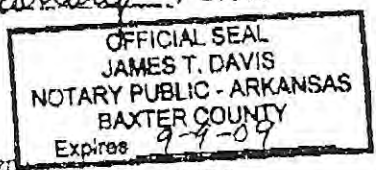

James T. Davis
Notary Public

DATED: _____
Subscribed and sworn to before me this _____ day of _____, 2001.

Notary Public

DATED: _____
Subscribed and sworn to before me this _____ day of _____, 2001.

Notary Public

DATED: _____
Subscribed and sworn to before me this _____ day of _____, 2001.

Notary Public

I, Carolyn Hayes, City Clerk Walnut Ridge, Arkansas, do hereby certify to the County Clerk, Lawrence County Arkansas that the attachments hereto are true and correct copies of Ordinance #650-01, plat and qualifying affidavit thereto.

DATE: 02-14-01

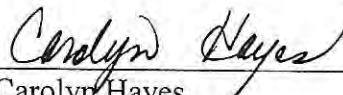

Carolyn Hayes
City Clerk, Walnut Ridge, AR



ARKANSAS SECRETARY OF STATE

MARK MARTIN

January 04, 2017

The Honorable Tina Stowers
Lawrence County Clerk
P.O. Box 526
Walnut Ridge, AR 72476

Re: City of Walnut Ridge Annexation Ordinance 648-01

Dear Mr. Holliday,

This letter acknowledges receipt and filing of the following notice of municipal boundary change by the Office of the Secretary of State:

Filing Type: Annexation by petition pursuant to A.C.A § 14-40-602 (petition by a majority of the landowners)

Effective Date: unknown

County: Lawrence City: Walnut Ridge

City Ordinance: 648-01 Dated: 1/9/2001

County Court Order: Unknown

File marked copies of the Ordinance and supporting documents submitted to our Office are enclosed. By copy of this letter (and its enclosures), the Secretary of State hereby notifies the appropriate mapping authorities for Arkansas. Please retain these copies as official record of the filing of the municipal boundary change by the Arkansas Secretary of State.

If you have any questions or concerns regarding this filing please contact our office at 501-682-3401.

Sincerely,

A handwritten signature in cursive script that reads "Cynthia Fisher".

Cynthia Fisher
Arkansas Secretary of State Legal Division
500 Woodlane St, Room 256
Little Rock, AR 72201
501-682-3401

cc: Arkansas Geographic Information Systems Office (w/ encl)
Arkansas Highway and Transportation Department Mapping Department (w/ encl)
UALR Institution for Economic Advancement (w/encl)
Tom-Tom (w/encl)
Ms. Sharon Henson, Walnut Ridge City Clerk and Trasurer





Arkansas Secretary of State

Mark Martin Arkansas Secretary of State, 500 Woodlane Ave, Little Rock, AR 72201-1094

Municipal Boundary Change Checklist

County: Lawrence City/Town: Walnut Ridge

City Ordinance/Resolution No: 648-01 Date approved: 01/09/2001

County Court Case No: _____ Date Order Filed: _____

Type: Annexation by Petition majority of Landowners A.C.A §14-40-602

Date Change Effective: _____ Emergency clause: Yes No

For Circuit Court Challenge: Date Filed: _____ Upheld Overturned Other (attach explanation)

Initiating party:

All Landowners Majority Landowners Municipal Governing Body State Other _____

Supporting Documentation attached (check all that apply):

- File marked copy of City Ordinance/Resolution (not required for A.C.A § 14-40-1801)
- File marked copy of County Court Order (not required for A.C.A. § 14-40-501)
- Proof of Publication for all Legal Notices (Hearing, Election, City Ordinance/Resolution)
- Copy of Arkansas GIS approved printed map and certification letter
- File marked copy of Petition Part or File marked copy of the certified special election results (if applicable)
- File marked copy of Complaint and final Circuit Court Order (Court Challenge only)

Municipal Contact:

Name: Ms. Sharon Henson Title: Walnut Ridge City Clerk and Treasurer

Street Address: 300 West Main ST

City: Walnut Ridge St: AR Zip code: 72476

City/County Official:

Signature: Hon. Tina Stower Title: Lawrence County Clerk

Date: 12/20/2016

Complete one form for each ordinance/resolution and attach it as a cover page to the supporting document set. Submit the documents to Arkansas Secretary of State, Atten: Municipal Boundary Filing, 500 Woodlane Ave, Little Rock, AR 72201-1094

Office of the Arkansas Secretary of State use only

Received by:

FILED
JAN 04 2017
Arkansas
Secretary of State

ORDINANCE NO. 648-01

2001 FEB -7 AM 8:22

AN ORDINANCE CONFIRMING THE ANNEXATION OF THE FOLLOWING DESCRIBED LANDS:

Tract No. 1:

All Lands lying within the perimeters of a boundary described as follows:

Beginning at a point at the northeast corner of Section 1, Township 16 North, Range 1 East, thence go southerly along the east section line of Section 1 and Section 12 to the southeast corner of Section 12, thence go westerly along the section line between Section 12 and Section 13, Section 11 and Section 14, and Section 10 and Section 15 to the southwest corner of the East Half of the Southwest Quarter of Section 10, which is the Hoxie City Limit, thence go northerly along the west line of said East half, Southwest Quarter, Section 10 (Hoxie City Limit Line) to the northwest corner of said East Half, Southwest Quarter, Section 10, thence go easterly along the North line of said East Half, Southwest Quarter, Section 10 (Hoxie City Limit Line) to the center of said Section 10, thence go northerly along the quarter section line between the Northeast Quarter and Northwest Quarter of said Section 10 (Hoxie City Limit Line) to the northwest corner of said Northeast Quarter, Section 10 (Hoxie City Limit Line), thence go easterly along the north section line of said Section 10 to the northeast corner of Section 10, thence go northerly along the west line of section 2, to the Northwest corner of said Section 2 (which is Walnut Ridge City Limit line), thence go easterly along the north section of said Section 2 and Section 1 to the northeast corner of said Section 1, which is the point of beginning, all being in Township 16 North, Range 1 East, Lawrence County, Arkansas. Also described as all of Section One (1); all of Section Two (2); the East half of the Southwest Quarter (E 1/2 SW 1/4) and the East Half (E 1/2) of Section Ten (10); all of Section Eleven (11) and all of Section Twelve (12), all said lands lying in Township Sixteen (16) North, Range One (1) East in Lawrence County, Arkansas.

(1)

FILED

JAN 04 2017

Arkansas
Secretary of State

Tract No. 2:

BEGINNING AT THE EXTREME SOUTHWEST CORNER OF THE EXISTING CITY LIMIT WHICH POINT IS THE INTERSECTION OF THE NORTH RIGHT-OF-WAY OF JAY STREET AND THE NORTH-SOUTH 1/4 SECTION LINE OF SECTION 33, T-17-N, R-1-E, THENCE NORTHERLY ALONG SAID NORTH-SOUTH 1/4 SECTION LINE TO THE NORTH LINE OF SAID SECTION 33, THENCE EASTERLY ALONG SAID NOTRH SECTION LINE TO THE SOUTHWEST CORNER OF SECTION 27, THEN GO NORTHERLY ALONG THE WEST LINES OF SECTION 27, SECTION 22 TO THE NORTHWEST CORNER SECTION 22, THEN GO EASTERLY ALONG THE NORTH LINE OF SECTION 22 TO THE NORTHEAST CORNER OF SECTION 22 THEN GO NORTHERLY ALONG WEST SECTION LINE OF SECTION 14 TO THE NORTHWEST CORNER OF SECTION 14, THEN GO EASTERLY ALONG THE NORTH SECTION LINES OF SAID SECTION 14 AND SECTION 13 TO THE NORTHEAST CORNER OF SECTION 13, THEN GO SOUTHERLY ALONG THE EAST SECTION LINES OF SECTION 13, SECTION 24, SECTION 25, AND SECTION 36 TO THE SOUTHEAST CORNER SECTION 36, ALL BEING LOCATED IN T-17-N, R-1-E, THEN GO WESTERLY ALONG THE SOUTH SECTION LINE OF SECTION 36 AND SECTION 35 TO THE INTERSECTION OF THE NORTH RIGHT-OF-WAY LINE OR ARK HWY 91 TO THE EXISTING SOUTHEAST CITY LIMIT LINE OF THE CITY OF WALNUT RIDGE, WHICH IS THE END OF THE NEW CITY LIMIT BOUNDARY LINE.

Be it ordained by the City Council of Walnut Ridge, Arkansas:

1. The City Council of Walnut Ridge, Arkansas does hereby accept the following territory into the City of Walnut Ridge, Arkansas:

Tract No. 1:

All Lands lying within the perimeters of a boundary described as follows:

Beginning at a point at the northeast corner of Section 1, Township 16 North, Range 1 East, thence go southerly along the east section line of Section 1 and Section 12 to the southeast corner of Section 12, thence go westerly along the section line between Section 12 and Section 13, Section 11 and Section 14, and Section 10 and Section 15 to the southwest corner of the East Half of the Southwest Quarter of Section 10, which is the Hoxie City Limit, thence go northerly along the west line of said East half, Southwest Quarter, Section 10 (Hoxie City Limit Line) to the northwest corner of said East Half, Southwest Quarter, Section 10, thence go easterly along the North line of said East Half, Southwest Quarter, Section 10 (Hoxie City Limit Line) to the center of said Section 10, thence go northerly along the quarter section line between the Northeast Quarter and Northwest Quarter of said Section 10 (Hoxie City Limit Line) to the northwest corner of said Northeast Quarter, Section 10 (Hoxie City Limit Line), thence go easterly along the north section line of said Section 10 to the northeast corner of Section 10, thence go northerly along the west line of section 2, to the Northwest corner of said Section 2 (which is Walnut Ridge City Limit line), thence go easterly along the north section of said Section 2 and Section 1 to the northeast corner of said Section 1, which is the point of beginning, all being in Township 16 North, Range 1 East, Lawrence County, Arkansas. Also described as all of Section One (1); all of Section Two (2); the East half of the Southwest Quarter (E ½ SW 1/4) and the East Half (E ½) of Section Ten (10); all of Section Eleven (11) and all of Section Twelve (12), all said lands lying in Township Sixteen (16) North, Range One (1) East in Lawrence County, Arkansas.

Tract No. 2:

BEGINNING AT THE EXTREME SOUTHWEST CORNER OF THE EXISTING CITY LIMIT WHICH POINT IS THE INTERSECTION OF THE NORTH RIGHT-OF-WAY OF JAY STREET AND THE NORTH-SOUTH 1/4 SECTION LINE OF SECTION 33, T-17-N, R-1-E, THENCE NORTHERLY ALONG SAID NORTH-SOUTH 1/4 SECTION LINE TO THE NORTH LINE OF SAID SECTION 33, THENCE EASTERLY ALONG SAID NOTRH SECTION LINE TO THE SOUTHWEST CORNER OF SECTION 27, THEN GO NORTHERLY ALONG THE WEST LINES OF SECTION 27, SECTION 22 TO THE NORTHWEST CORNER SECTION 22, THEN GO EASTERLY ALONG THE NORTH LINE OF SECTION 22 TO THE NORTHEAST CORNER OF SECTION 22 THEN GO NORTHERLY ALONG WEST SECTION LINE OF SECTION 14 TO THE NORTHWEST CORNER OF SECTION 14, THEN GO EASTERLY ALONG THE NORTH SECTION LINES OF SAID SECTION 14 AND SECTION 13 TO THE NORTHEAST CORNER OF SECTION 13, THEN GO SOUTHERLY ALONG THE EAST SECTION LINES OF SECTION 13, SECTION 24, SECTION 25, AND SECTION 36 TO THE SOUTHEAST CORNER SECTION 36, ALL BEING LOCATED IN T-17-N, R-1-E, THEN GO WESTERLY ALONG THE SOUTH SECTION LINE OF SECTION 36 AND SECTION 35 TO THE INTERSECTION OF THE NORTH RIGHT-OF-WAY LINE OR ARK HWY 91 TO THE EXISTING SOUTHEAST CITY LIMIT LINE OF THE CITY OF WALNUT RIDGE, WHICH IS THE END OF THE NEW CITY LIMIT BOUNDARY LINE.

2. A copy of the plat of the annexed real estate is attached to this Ordinance. The County Clerk is hereby requested pursuant to A.C.A. 14-40-605 to forward a copy of this Ordinance along with a copy of the plat of the annexed territory and the Order of the County Court to the Secretary of State and also to the Director of the Tax Division of the Arkansas Public Service Commission.

DATED this 9th day of January, 2008.



Mayor

ATTEST:



Clerk

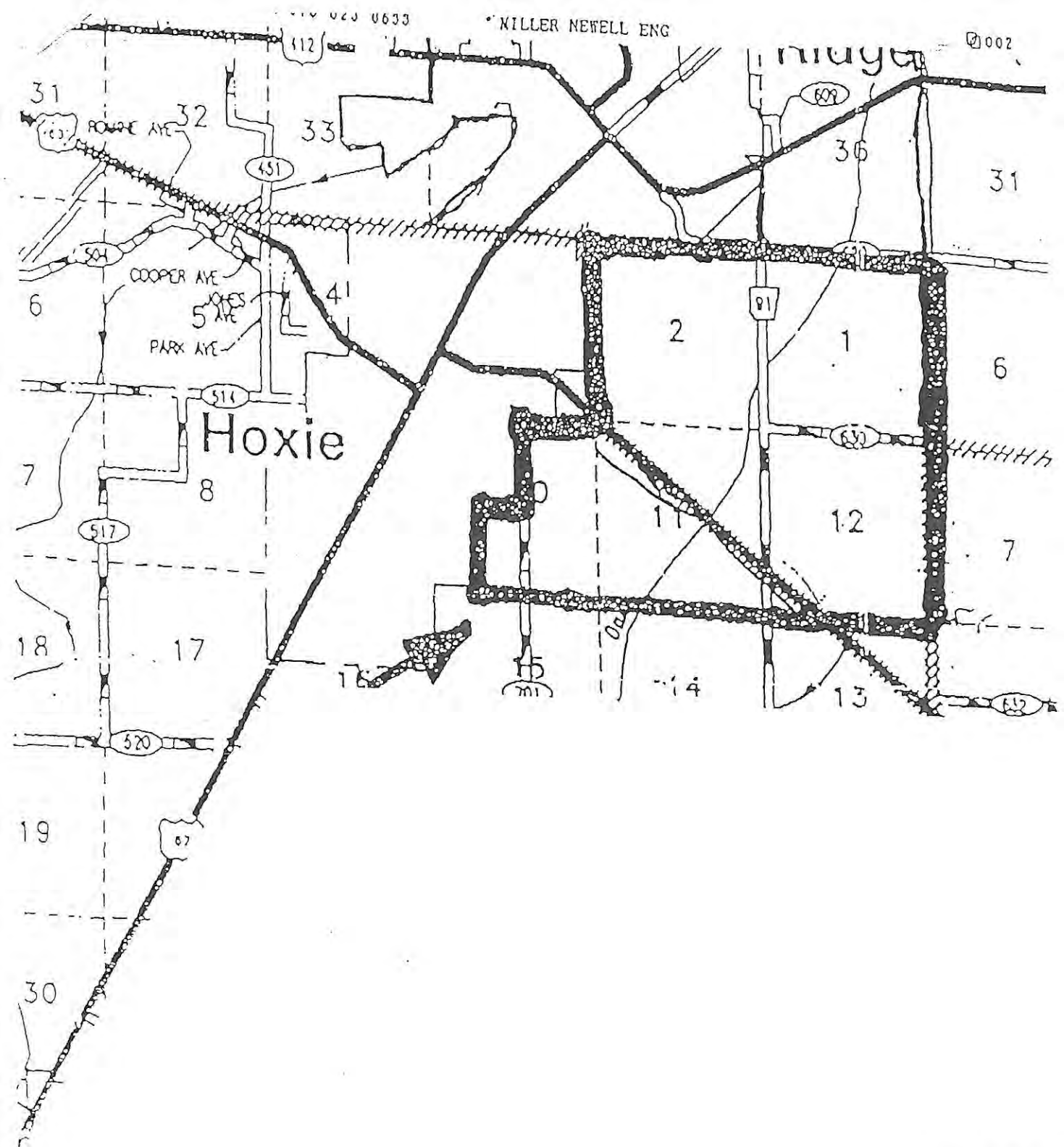

FILED

JAN 04 2017

Arkansas
Secretary of State

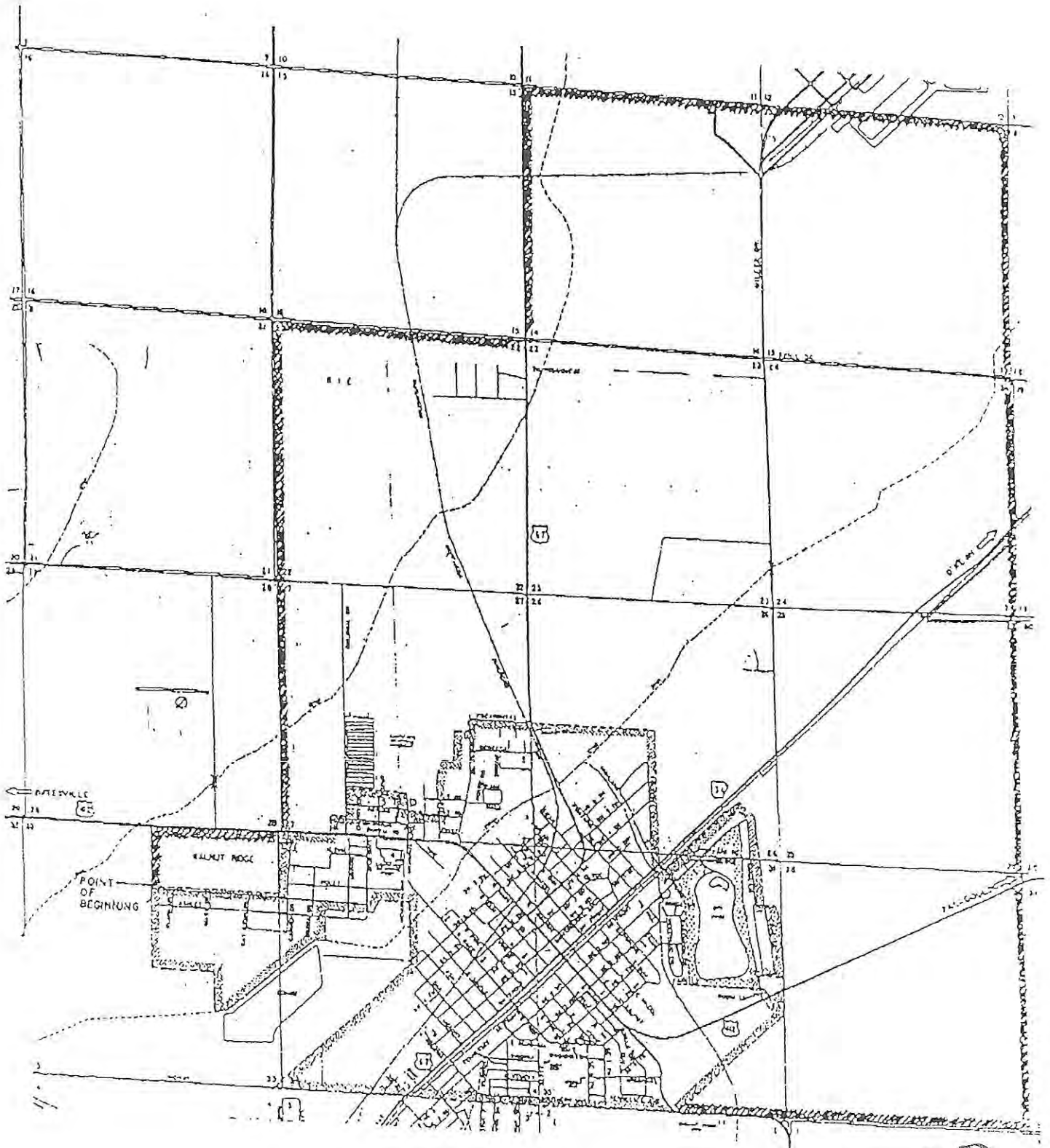

FILED

JAN 04 2017

Arkansas
Secretary of State

I do hereby certify that the annexed
and foregoing instrument of writing
is a true and correct copy of
Ordinance No. 148-01

Jina Stowers
County Clerk

By Sarah Masterson DC

.....
Lawrence County

February 7, 2001

Reference: Annexation of Walnut Ridge

An ordinance confirming the annexation of lands within the city of Walnut Ridge was recently passed on January 9, 2001 by the Walnut Ridge city council. Therefore, the 9-1-1 coordinator and the county clerk are hereby, authorized to send you a change of address, due to voter registration and emergency 911 purposes. If you would like more information, or if you feel this is an error, please contact Walnut Ridge City Hall.

Karen Swartzlander
Deputy Clerk

Peggy Miles
9-1-1 Coordinator

FILED
JAN 04 2017
Arkansas
Secretary of State

I do hereby certify that the annexed
and foregoing instrument of writing
is a true and correct copy of

Letter
Ima Stowers
County Clerk

By Sarah Masterson DC