



# State of Arkansas Secretary of State

Business & Commercial Services 682-3409  
Elections 682-5070  
Building & Grounds 682-5532  
Communications & Education 683-0057  
State Capitol Police 682-5173  
Business Office 682-8032  
Information Technology 682-3411

**Charlie Daniels**  
Secretary of State

November 19, 2004

The Honorable Ruth Trent  
Crittenden County Clerk  
100 Court Square  
Marion, AR 72364

Dear Ms. Trent:

The Following Information has been recorded and filed in the Office of the Secretary of State:

Date: 11/15/2004 County: Crittenden City: West Memphis

Annexation: Ordinance No. - 2106  
Co. Order No - 2003-89  
Plat - X  
Election -  
Island -  
Ordinance No. -  
Co. Order No. -  
Plat -  
Election -

Incorporation: Census Information  
1st Class City -  
2nd Class City -  
Incorporated Town -

I have forwarded this information to the Arkansas Municipal League. If you have any further questions please do not hesitate to contact me at 1-800-482-1127 or 682-3452.

Sincerely,

Tena Arnold  
Election Services Representative

Room 256 State Capitol • Little Rock, Arkansas 72201-1094  
501-682-1010 • Fax 501-682-3510

e-mail: [sos@aristotle.net](mailto:sos@aristotle.net) • [www.sos.arkansas.gov](http://www.sos.arkansas.gov)

ORDINANCE NO. 2106

**AN ORDINANCE ATTACHING AND INCORPORATING CERTAIN DESCRIBED ANNEXED TERRITORY TO WARD 1 OF THE CITY OF WEST MEMPHIS AND FOR OTHER PURPOSES.**

**WHEREAS**, A.C.A. § 14-40-203 requires that when any territory shall have been annexed to any incorporated town or city, it may be, and it is the duty of the town or city council of the incorporated town or city to attach and incorporate the annexed territory to and in one (1) or more wards of the incorporated town or city lying adjacent thereto; and

**WHEREAS**, the following described territory has been annexed to the City of West Memphis and is adjacent to Ward 1 of the City of West Memphis, to-wit:

Lots 20 and 21 of the J. C. Rainer Subdivision, Crittenden County, Arkansas, as shown by plat of record in Plat Book 2 at page 13, lying in the South Half of Section 10, T-6-N, R-8-E.

NOW, THEREFORE, BE IT ORDAINED BY THE CITY COUNCIL OF THE CITY OF WEST MEMPHIS, ARKANSAS, THAT:

**SECTION 1.** The following described lands and territory contiguous to and adjoining the City of West Memphis, Arkansas, be and the same are hereby accepted and annexed

to and made a part of the City of West Memphis, Arkansas,  
to-wit:

Lots 20 and 21 of the J. C. Rainer  
Subdivision, Crittenden County,  
Arkansas, as shown by plat of record in  
Plat Book 2 at page 13, lying in the  
South Half of Section 10, T-6-N, R-8-E.

**SECTION 2:** The above described territory is hereby  
attached and incorporated to Ward 1 of the City of West  
Memphis, Arkansas, and is zoned I-1, Limited Industrial  
District.

**SECTION 3:** All ordinances or resolutions or parts  
of ordinances or resolution in conflict herewith are hereby  
repealed to the extent of any such conflict.

**PASSED AND APPROVED** this 4th day of November,  
2004.

  
WILLIAM H. JOHNSON, Mayor

  
PHILLIP PARA, City Clerk

SPONSORED BY: \_\_\_\_\_

**RECEIVED**  
City Clerk's Office  
Date/Time 10-4-04 11:30am  
By Dorethy Wallace  
DAE

**CERTIFICATE**



NOV 15 2004

STATE OF ARKANSAS )  
( SS  
COUNTY OF CRITTENDEN )

CHARLIE DANIELS  
SECRETARY OF STATE

BY \_\_\_\_\_

The undersigned, City Clerk of the City of West Memphis, Arkansas, hereby

certifies that the above and foregoing is a true and complete and correct copy of

Ordinance No. 2106 An Ordinance attaching and incorporating  
certain described annexed territory to Ward 1 of the City of  
West Memphis and for other purposes.

\_\_\_\_\_ as the same appears in the official records of said City.

IN WITNESS WHEREOF, I have hereunto set my hand as City Clerk of the  
City of West Memphis, Arkansas, and the Official Seal of said City, on this 8th  
day of November, 2004.

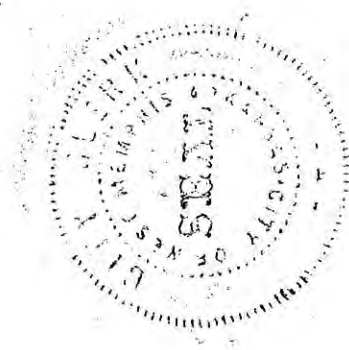

*Andy Greenwood*  
CITY CLERK, CITY OF WEST MEMPHIS  
CRITTENDEN COUNTY, ARKANSAS

IN THE COUNTY COURT OF CRITTENDEN COUNTY, ARKANSAS

635  
(A-25)

FILED

AT \_\_\_\_\_ O'CLOCK \_\_\_\_\_ M

OCT 16 2003

RUTH TRENT, CLERK

BY \_\_\_\_\_

NO. CO-2003-89

IN THE MATTER OF THE ANNEXATION TO  
THE CITY OF WEST MEMPHIS, ARKANSAS,  
OF LOTS 20 AND 21 OF THE J.C. RAINER  
SUBDIVISION, LYING IN THE SOUTH HALF  
OF SECTION 10, TOWNSHIP SIX NORTH,  
RANGE EIGHT EAST, CRITTENDEN COUNTY,  
ARKANSAS.

ORDER GRANTING ANNEXATION

Now on this 14th day of October, 2003, this matter came on for hearing. The Petitioners, James A. Bacon and Claire A. Bacon, are represented by William C. Ayres, Jr. The matter was submitted to the Court upon the pleadings and other matters and things. From a review of the pleadings, the exhibits, and other matters and things appearing to the Court, the Court doth find as follows:

1. This Court has jurisdiction of the subject matter.
2. A hearing date was set not less than thirty (30) days after the filing of the Petition asking for such annexation.
3. That between the time of the filing of the Petition and the date of this hearing, the Petitioners have caused Notice to be published in the Evening Times, a newspaper published in Crittenden County, Arkansas, which has a general circulation in this county, once a week for three (3) consecutive weeks.

FILED

OCT 16 2004

CHARLIE DANIELS  
SECRETARY OF CLERK

034

4. The published Notice contained the substance of the Petition filed in this matter and also the time and place set for a hearing upon the Petition.

5. The Court finds that all of the land to be annexed is owned entirely by the Petitioners, James A. Bacon and Claire A. Bacon.

6. The allegations of the Petition filed with the Court are sustained by the proof, and in particular, the Petitioners constitute a majority of the real estate owners of the lands to be annexed as described in the Petition and in accordance with A. C. A. § 16-40-601(a). The limits of the territory requested by the Petitioners to be annexed to the City of West Memphis, Arkansas, has been filed herein, and the prayer of the Petitioners is right and proper and should be granted.

IT IS THEREFORE, BY THE COURT, CONSIDERED, ORDERED and ADJUDGED that the Petition of James A. Bacon and Claire A. Bacon for annexation of the following described territory should be, and the same hereby is, granted, and that such territory should be, and the same is hereby annexed to the City of West Memphis, Arkansas, as follows to wit:

Lots 20 and 21 of the J. C. Rainer  
Subdivision, Crittenden County,  
Arkansas, as shown by plat of record in  
Plat Book 2 at page 13, lying in the  
South Half of Section 10, T-6-N, R-8-E.

637

IT IS FURTHER ORDERED THAT no further action be taken for a period of thirty (30) days as provided by law to allow the institution of proceedings to prevent such annexation if any party should desire to take such action under the laws of this state and, accordingly, this cause is continued until the 24th day of November, 2003.

Melba Holt  
COUNTY JUDGE

STATE OF ARKANSAS  
COUNTY OF CRITTENDEN  
I HEREBY CERTIFY THIS TO BE A  
TRUE COPY AS APPEARS OF RECORDS  
IN MY OFFICE THIS 24th day of Nov. 2003  
Ruth Trout  
PROBATE CLERK  
Caryn McCallister D.C.



SCALE 1" = 50'

**LOT 20**  
**J.C. RAINER SUBDIVISION**  
**LYING IN THE SE 1/4 OF SECTION 10, T-6-N, R**  
**CRITTENDEN COUNTY, ARKANSAS**

2575.27'

METAL FENCE

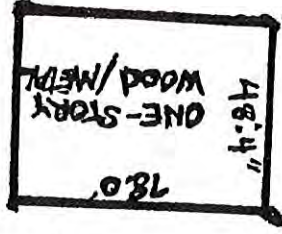

161.0'

22' CURB

165.0'

60' RM

STATE HIGHWAY No. 70

STATE OF ARKANSAS  
COUNTY OF CRITTENDEN  
I HEREBY CERTIFY THIS TO BE A  
TRUE COPY AS APPEARS OF RECORDS  
IN MY OFFICE THIS 11th day of Nov 2004

BY Charles M. Williams D.C.  
PROBATE CLERK

**FILED**

NOV 15 2004

CHARLIE DANIELS  
SECRETARY OF STATE





SCALE 1" = 50'

2575.27'

2575.27'

METAL FRG

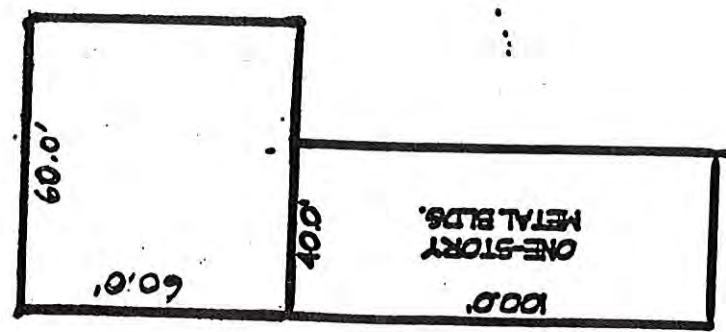

161.0'

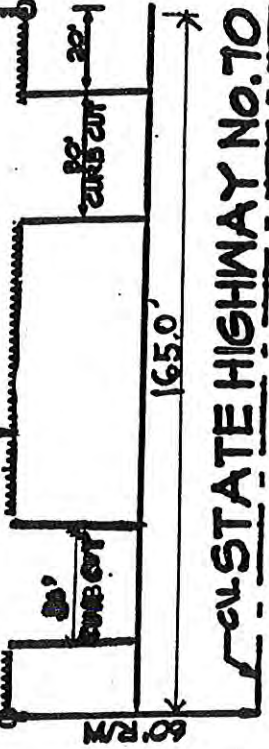

LOT 21  
 J.C. RAINER SUBDIVISION  
 LYING IN THE SE 1/4 OF SECTION 10, T-6-N, R  
 CRITTENDEN COUNTY, ARKANSAS

STATE OF ARKANSAS  
 COUNTY OF CRITTENDEN  
 I HEREBY CERTIFY THIS TO BE A  
 TRUE COPY AS APPEARS OF RECORDS  
 IN MY OFFICE THIS 21<sup>st</sup> DAY OF 20 05

BY *C. Campbell* PROBATE CLERK  
 D.C.