

BAS Correction Historic Annex Ordinance 2008-3 : City of Monette
 *for Census only - was already in state map

City: Monette
 Mayor: Jerry Qualls

Arkansas Code 14-40-101.

Before an entity undertakes an annexation, consolidation, or detachment proceeding under this chapter, the entity shall coordinate with the Arkansas Geographic Information Systems Office for preparation of legal descriptions and digital mapping for the relevant annexation, consolidation, and detachment areas.

The map contained herein, is evidence, the entity has met requirements of Act 914 of 2015

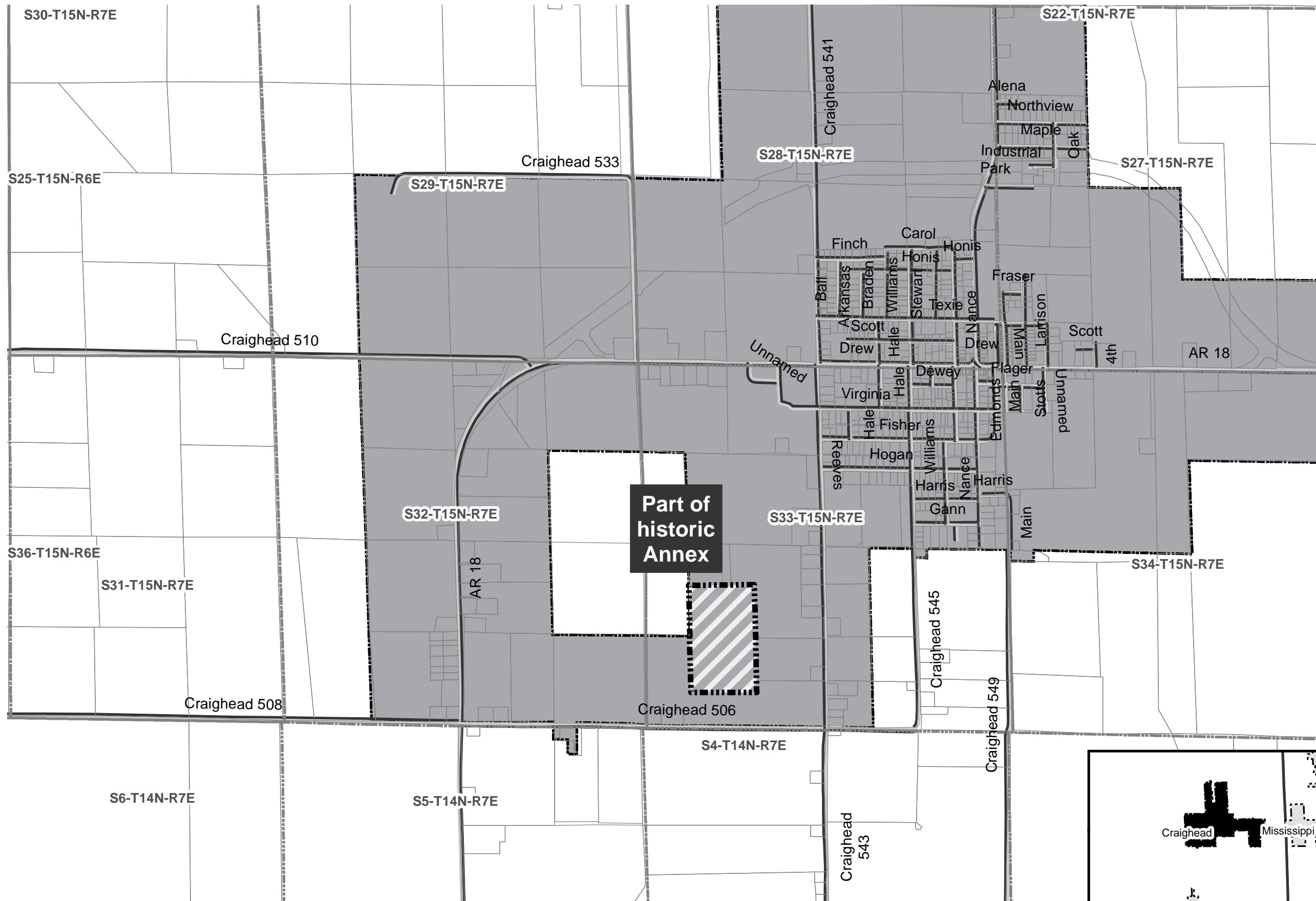

- Proposed Annex
- Sections
- Parcels
- Minor Road
- Existing City
- Neighboring City

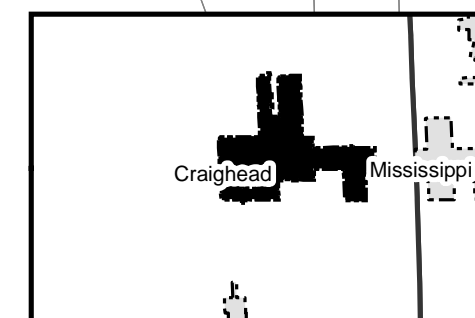
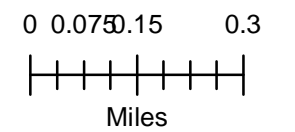



State of Arkansas Secretary of State

Charlie Daniels
Secretary of State

Business & Commercial Services	682-3409
Elections	682-5070
Building & Grounds	682-3407
Communications & Education	683-0057
State Capitol Police	682-5173
Business Office	682-8032
Information Technology	682-3411

December 9, 2008

The Honorable Nancy Nelms
Craighead County Clerk
511 South Main Street
Jonesboro, AR 72401

Dear Ms. Nelms:

The Following Information has been recorded and filed in the Office of the Secretary of State:

Date: November 4, 2008 **County:** Craighead **City:** Monette

Annexation:	Ordinance No.	-	2008-3
	County Order No	-	2008-4
	Plat	-	
	Election	-	XXX
	Island	-	
Incorporation:	Ordinance No.	-	
	Co. Order No.	-	
	Plat	-	
	Election	-	

Census Information: The following City or Town has been upgraded or reduced to:

- 1st Class City -
- 2nd Class City -
- Incorporated Town -

I have forwarded this information to the Arkansas Municipal League and the Arkansas Highway and Transportation Department and the Arkansas State Data Center. If you have any further questions please do not hesitate to contact me at 1-800-482-1127 or 682-3451.

Sincerely,

Nancy Crockett
Election Services Representative
Arkansas Secretary of State

ORDINANCE NO. 2008-3

FILED

DEC 08 2008

CHARLIE DANIELS
SECRETARY OF STATE

AN ORDINANCE SUBMITTING TO THE VOTERS OF THE CITY OF MONETTE, ARKANSAS, AND OTHER AFFECTED PERSONS, THE QUESTION OF ANNEXATION TO SAID CITY OF MONETTE CERTAIN CONTIGUOUS TERRITORY; AND DECLARING AN EMERGENCY BY

WHEREAS, it appears to the City Council of the City of Monette, Arkansas, that the annexation of certain hereinafter described territory, contiguous to the City of Monette, is necessary for the orderly growth and development of the City; and

WHEREAS, the lands are needed for proper municipal purposes; and

WHEREAS, the lands are valuable by reason of their adaptability for prospective municipal uses.

NOW, THEREFORE, BE IT ORDAINED BY THE CITY COUNCIL OF THE CITY OF MONETTE, ARKANSAS:

SECTION 1. That there shall be submitted to the qualified electors of the City of Monette and of the following described area, the question of the annexation of the following described territory to the City of Monette:

A proposed annexation to the city of Monette, Arkansas which is adjacent to and contiguous with the existing corporate boundaries, being more particularly described as follows: Beginning at the intersection of the north right of way line of Craighead county road 508 and the west line of the SE 1/4 SW 1/4 of section 32 Township 15 North Range 7 East, thence run North along the west line of the SE 1/4 SW 1/4, NE 1/4 SW 1/4, SE 1/4 NW 1/4 and the NE 1/4 NW 1/4 of said section 32 to the southwest corner of the SE 1/4 SW 1/4 of section 29 Township 15 North Range 7 East, thence run North along the west line of the SE 1/4 SW 1/4 and the NE 1/4 SW 1/4 to the northwest corner of the NE 1/4 SW 1/4 of said section 29, thence run East along the north line of the said NE 1/4 SW 1/4 to the northeast top bank of a drainage canal, thence intersect a line being parallel with said northeast top bank with the south right of way line of Craighead county road 533, thence run East along the said south right of way line to the intersection of the south and east right of way lines of said Craighead county road 533, thence run along a line being parallel with the said east right of way to the intersection with the north line of the NW 1/4 SW 1/4 of section 28 Township 15 North Range 7 East, thence run East along the north line of the said NW 1/4 SW 1/4 to the northwest corner of the NE 1/4 SW 1/4 of said section 28, thence run North along the west line of the SE 1/4 NW 1/4 and the NE 1/4 NW 1/4 of said section 28 to the southwest corner of the SE 1/4

State of Arkansas
County of Craighead
A True Copy / Certify
Nancy Nelms, County & Probate Clerk
By 

FILED

AUG 22 2008

NANCY NELMS
COUNTY & PROBATE COURT CLERK

FILED

DEC 08 2008

CHARLIE DANIELS
SECRETARY OF STATE

SW ¼ of section 21 Township 15 North Range 7 East, thence run North along the west line of the SE ¼ SW ¼, NE ¼ SW ¼, SE ¼ NW ¼ and the NE ¼ NW ¼ of said section 21 to the intersection with the south right of way line of Craighead county road 514, thence run East along the said south right of way line of Craighead county road 514 to the intersection with the west right of way line of Craighead county road 541, thence continue East along the said south right of way line of Craighead county road 514 to the east line of the NE ¼ NW ¼ of said section 21, thence run North to the southwest corner of the SW ¼ SE ¼ of section 16 Township 15 North Range 7 East, thence run North along the west line of the said SW ¼ SE ¼ of section 16 to the north right of way line of Craighead county road 514, thence run North 300 ft. along the said west line of the SW ¼ SE ¼ of section 16, and being the west line of a tract, to the northwest corner of said tract, thence run East 150.00 ft. to the northeast corner of the said tract, thence run South 300 ft. along the east side of said tract to the north right of way line of Craighead county road 514, thence run West along the said north right of way line 150.00 ft. to a point, thence run South to the southwest corner of the SW ¼ SE ¼ of said section 16, also being the northeast corner of the NE ¼ NW ¼ of said section 21, thence run South along the east line of the said NE ¼ NW ¼ of section 21 to the intersection with the north right of way line of Craighead county road 514, thence run West along the said north right of way line to the said intersection with the west right of way line of Craighead county road 541, thence run South along the said west right of way line of Craighead county road 541 thru the NE ¼ NW ¼ and the SE ¼ NW ¼ of section 21 to a point, said point being in alignment with the north line of lands described as part of the Southwest one quarter of the Northeast one quarter of section 21 Township 15 North Range 7 East, Craighead county, Arkansas, being more particularly described as follows: Begin at the center of section 21, Township 15 North Range 7 East, Craighead county, Arkansas, thence South 86 degrees 46' 44" East 30.05 ft. to the Point of Beginning Proper, thence North 00 degrees 00' 00" East 203.22 ft., thence North 90 degrees 00' 00" East 208.38 ft., thence South 00 degrees 00' 00" West 214.95 ft., thence North 86 degrees 46' 44" West 208.71 ft. to the Point of Beginning Proper, and being subject to all rights of way and easements of record, thence from said point run East to the northwest corner of the described tract, thence from the said northwest corner of the herein described tract run East to the northeast corner of the said tract, thence run South to the southeast corner of the said tract, thence run West to the southwest corner of the said tract, thence run West to the west right of way line of Craighead county road 541, thence run South along the said west right of way line thru the NE ¼ SW ¼ of section 21 to

FILED

DEC 08 2008

**CHARLIE DANIELS
SECRETARY OF STATE**

a point, said point being in alignment with the north line of lands described as part of the Northwest one quarter of the Southeast one quarter of section 21 Township 15 North Range 7 East, being more particularly described as follows: Commence at the southwest corner of the said Northwest one quarter of the Southeast one quarter; thence North 00 degrees 01' 17" East 136.00 ft. to the Point of Beginning, thence continue North 00 degrees 01' 17" East 150.00 ft., thence South 89 degrees 15' 03" East 290.40 ft., thence South 00 degrees 01' 17" West 150.00 ft., thence North 89 degrees 15' 03" West 290.40 ft. to the Point of Beginning, containing 1.0 acre, subject to road right of way on the west side, thence from said point run East to the northwest corner of the described tract, thence run East to the northeast corner of the described tract, thence run South to the southeast corner of the described tract, thence run West to the southwest corner of the described tract, thence run West to the west right of way line of Craighead county road 541, thence run South along the said west right of way line of Craighead county road 541 to the intersection with the north line of section 28 Township 15 North Range 7 East, thence run East along the north line of the NW $\frac{1}{4}$ NE $\frac{1}{4}$ of section 28 to the northeast corner of the NW $\frac{1}{4}$ NE $\frac{1}{4}$ of said section 28 and being also the southwest corner of the SE $\frac{1}{4}$ SE $\frac{1}{4}$ of section 21 Township 15 North Range 7 East, thence run North thru section 21 Township 15 North Range 7 East along the west line of the SE $\frac{1}{4}$ SE $\frac{1}{4}$, NE $\frac{1}{4}$ SE $\frac{1}{4}$, SE $\frac{1}{4}$ NE $\frac{1}{4}$ and the NE $\frac{1}{4}$ NE $\frac{1}{4}$ to the intersection of the south right of way line of Craighead county road 514, thence run East along the south right of way line of said Craighead county road 514 to the intersection of the west right of way line of Arkansas Highway 139, thence run East to the intersection of the east right of way line of Arkansas Highway 139 and the south right of way line of Craighead county road 516, thence run East along the south right of way line of said Craighead county road 516 to the intersection of the said south right of way line and the east line of the NW $\frac{1}{4}$ NW $\frac{1}{4}$ of section 22 Township 15 North Range 7 East, thence run South along the east line of the NW $\frac{1}{4}$ NW $\frac{1}{4}$, SW $\frac{1}{4}$ NW $\frac{1}{4}$, NW $\frac{1}{4}$ SW $\frac{1}{4}$ and the SW $\frac{1}{4}$ SW $\frac{1}{4}$ of said section 22 to the northeast corner of the NW $\frac{1}{4}$ NW $\frac{1}{4}$ of section 27 Township 15 North Range 7 East, thence run South along the east line of the NW $\frac{1}{4}$ NW $\frac{1}{4}$ and the SW $\frac{1}{4}$ NW $\frac{1}{4}$ of the said section 27 to the northwest corner of the NE $\frac{1}{4}$ SW $\frac{1}{4}$ of section 27, thence run East along the north line of the said NE $\frac{1}{4}$ SW $\frac{1}{4}$ to the northeast corner of the said NE $\frac{1}{4}$ SW $\frac{1}{4}$, thence run South along the east line of the said NE $\frac{1}{4}$ SW $\frac{1}{4}$ to the northwest corner of the SW $\frac{1}{4}$ SE $\frac{1}{4}$ of section 27, thence run East along the north line of the SW $\frac{1}{4}$ SE $\frac{1}{4}$ and the SE $\frac{1}{4}$ SE $\frac{1}{4}$ of said section 27 to the northwest corner of the SW $\frac{1}{4}$ SW $\frac{1}{4}$ of section 26 Township 15 North Range 7 East, thence run East along

the north line of the SW ¼ SW ¼ and the SE ¼ SW ¼ of said section 26 to a point, said point being the southwest corner of lands described as the south 210 feet of the east 210 feet of the Northeast one quarter of the Southwest one quarter of section 26 Township 15 North Range 7 East, thence from said point run North 210.00 ft. to the northwest corner of the described tract, thence run East 210.00 ft. to the northeast corner of the described tract, thence run South 210.00 ft. to the southeast corner of the described tract and being the northwest corner of the SW ¼ SE ¼ of section 26 Township 15 North Range 7 East, thence run East along the north line of the SW ¼ SE ¼ and the SE ¼ SE ¼ of section 26 to the intersection of the west right of way line of Craighead county road 575, thence run South along the said west right of way line to the intersection with the north right of way line of Arkansas Highway 18, thence run South to the south right of way line of said Arkansas Highway 18, thence run parallel with said south right of way line to intersect with the east line of the NE ¼ NE ¼ of section 35 Township 15 North Range 7 East, thence run South to the southeast corner of the said NE ¼ NE ¼, thence run West to the northeast corner of the SW ¼ NE ¼ of said section 35, thence run South along the east line of the SW ¼ NE ¼, NW ¼ SE ¼ and the SW ¼ SE ¼ to the north right of way line of Craighead county road 562, thence run West along the said north right of way line of Craighead county road 562 to intersect with the east right of way line of Arkansas Highway 139, thence run along a line being parallel with the said east right of way line of Arkansas Highway 139 to intersect the south line of said section 35, thence run West along the south line of said section 35 to the southwest corner of the SE ¼ SW ¼, thence run North along the west line of the SE ¼ SW ¼, NE ¼ SW ¼ and the SE ¼ NW ¼ to the northwest corner of the said SE ¼ NW ¼, thence run West along the south line of the NW ¼ NW ¼ of said section 35 to the southeast corner of the NE ¼ NE ¼ of section 34 Township 15 North Range 7 East, thence run West along the south line of the NE ¼ NE ¼ and the NW ¼ NE ¼ to the southwest corner of the said NW ¼ NE ¼ of section 34, thence run South along the east line of the SE ¼ NW ¼ of said section 34 to the southeast corner of the said SE ¼ NW ¼, thence run West to the southeast corner of the SW ¼ NW ¼ of said section 34, thence run West along the south line of the said SW ¼ NW ¼ to a point, said point being in alignment with the east line of lands described as (1); Begin at the northwest corner of the NW ¼ SW ¼ of section 34 Township 15 North Range 7 East, thence S 00 degrees 00' 00" W along the section line 2.58 ft., thence S 88 degrees 31' 00" 62.93 ft. to the apparent east right of way of a public road, being the Point of Beginning Proper, thence S 88 degrees 03' 11" E 98.00 ft., thence S 01 degree 30' 12" W 32.76 ft.,

FILED

DEC 08 2008

CHARLIE DANIELS
SECRETARY OF STATE

thence S 86 degrees 35' 50" E 214.09 ft., thence S 00 degrees 00' 00" W 128.51 ft., thence N 87 degrees 19' 04" W 311.19 ft. to the apparent east right of way of a public road, thence N 00 degrees 01' 01" E 162.73 ft. to the Point of Beginning Proper, with exception and less the east (286.83 ft. ?) of the above described property containing 0.44 acres, more or less, and subject to all rights of way and easements of record, and (2); a part of the north five acres of the NW ¼ SW ¼ of section 34 Township 15 North Range 7 East, Craighead county, Arkansas being more particularly described as follows: Begin at the northwest corner of the NW ¼ SW ¼ of section 34 Township 15 North Range 7 East, thence S 00 degrees 00' 00" W along the section line 2.58 ft. to the Point of Beginning Proper, thence S 88 degrees 31' 00" E 62.93 ft. to the apparent east right of way of a public road, thence S 88 degrees 03' 11" E 98.00 ft., thence S 01 degree 30' 12" W 32.76 ft., thence S 86 degrees 35' 50" E 26.36 ft., thence S 00 degrees 00' 00" W (calc. 130.87 ft.) to the south property line, thence N 87 degrees 19' 04" W approximately 187.29 ft. (calc. 186.50 ft.) to the west line of section, thence N 00 degrees 00' 00" (calc. 161.41 ft.) to the Point of Beginning Proper, containing 0.68 acres, more or less, including property being West of the apparent east right of way line of the public road or East Main Street extended, thence from the previously described point in alignment with the east line of said lands run South to the southeast corner of the described tract (1), thence run West to the southeast corner of the described tract (2), being contiguous with the south line of the described tract (1), thence continue West to the southwest corner of the described tract (2) on the west line of the said section 34, thence run North along the said west line of section 34 to the Point of Beginning Proper of the described tract (2), thence continue North 2.58 ft. to the northwest corner of the said NW ¼ SW ¼ of section 34, also being the southeast corner of the SE ¼ NE ¼ of section 33 Township 15 North Range 7 East, thence run West along the south line of the said SE ¼ NE ¼ of section 33 to a point, said point being in alignment with the east side of lands described as being a part of the Northeast one quarter of the Southeast one quarter of section 33 Township 15 North Range 7 East, being more particularly described as follows: Begin at the northwest corner of the Northeast one quarter of the Southeast one quarter of section 33, thence South on the 40 acre line 27.00 ft. to the Point of Beginning Proper, thence South 88 degrees 21' East 175.00 ft., thence South 92.00 ft., thence North 88 degrees 21' West 175.00 ft. to the 40 acre line, thence North on the 40 acre line 92.00 ft. to the Point of Beginning Proper, subject to all right of way, existing easements of record, and building lines, thence from the said point run South to the northeast corner of the said tract, thence run South 92.00 ft. to

FILED

DEC 08 2008

CHARLIE DANIELS
SECRETARY OF STATE

the southeast corner of the said tract, thence run West 175.00 ft. to the southwest corner of the said tract and being on the 40 acre line, thence run North 92.00 ft. along the said 40 acre line to the Point of Beginning Proper, thence run North 27.00 ft. along the said 40 acre line to northwest corner of the Northeast one quarter of the Southeast one quarter of said section 33, and also being the southeast corner of the SW $\frac{1}{4}$ NE $\frac{1}{4}$, thence run West along the south line of the said SW $\frac{1}{4}$ NE $\frac{1}{4}$ to the northeast corner of the $\frac{1}{2}$ NW $\frac{1}{4}$ SE $\frac{1}{4}$ of said section 33, thence run South along the east line of the W $\frac{1}{2}$ NW $\frac{1}{4}$ SE $\frac{1}{4}$ and the W $\frac{1}{2}$ SW $\frac{1}{4}$ SE $\frac{1}{4}$ of said section 33 to the intersection with the north right of way line of Craighead county road 506, thence run West along the said north right of way line of Craighead county road 506 thru the W $\frac{1}{2}$ SW $\frac{1}{4}$ SE $\frac{1}{4}$, the SE $\frac{1}{4}$ SW $\frac{1}{4}$ and SW $\frac{1}{4}$ SW $\frac{1}{4}$ of said section 33 to the intersection with the east line of the SE $\frac{1}{4}$ SE $\frac{1}{4}$ of section 32 Township 15 North Range 7 East, thence run West along the said north right of way line of Craighead county road 506 thru the said SE $\frac{1}{4}$ SE $\frac{1}{4}$ of section 32 to a point, said point being in alignment with the east line of lands described as (1); a lot located in the northwest corner of the Northeast one quarter of the Northeast one quarter of section 5 Township 14 North Range 7 East, more particularly described as beginning at a point 208.7 ft. East of the northwest corner of the Northeast one quarter (East of the northwest corner of the Northeast one quarter of the Northeast one quarter ?) of section 5, being the Point of Beginning, thence South 417 ft., thence East 133 ft., thence North 417 ft., thence West 133 ft. to the Point of Beginning, one and one quarter ($1\frac{1}{4}$) acre more or less, and (2); one square acre in the northwest corner of the Northeast one quarter of the Northeast one quarter of section 5 Township 14 North Range 7 East, thence from the previously described point on the said north right of way line of Craighead county road 506 run South to the northeast corner of the described tract (1), thence run South 417.00 ft. to the southeast corner of the described tract (1), thence run West 133.00 ft. to the southwest corner of the described tract (1), thence run North 208.30 ft. to the southeast corner of the described tract (2), being contiguous with the west line of the described tract (1), thence run West 208.70 ft to the southwest corner of the described tract (2), thence run North 208.70 ft. to the northwest corner of the described tract (2), thence run North to the north right of way line of Craighead county road 506, thence run West along the said north right of way line of Craighead county road 506 to the intersection with the east right of way line of Arkansas Highway 18, thence run West to the intersection of the west right of way line of said Arkansas Highway 18 with the north right of way line of Craighead county road 508, thence run West along the said north right of way line of Craighead

FILED

DEC 08 2008

CHARLIE DANIELS
SECRETARY OF STATE

county road 508 to the Point of Beginning, LESS AND EXCEPT the SE ¼ NE ¼ and the NE ¼ SE ¼ of section 32 Township 15 North Range 7 East, and the W ½ SW ¼ NW ¼ and W ½ NW ¼ SW ¼ of section 33 Township 15 North Range 7 East, and, LESS AND EXCEPT any lands lying within the existing corporate boundaries and being annexed to the city of Monette, Arkansas prior to this proposed annexation written August 2008.

FILED

DEC 08 2008

CHARLIE DANIELS
SECRETARY OF STATE

BY _____

A map depicting said annexation area is attached hereto as Exhibit A and made a part hereof.

SECTION 2. The question of annexation of the territory described above in Section 1 shall be submitted to the electors qualified to vote on this issue at a special election to be held on Tuesday, November 4, 2008. Once this ordinance takes effect, the City Clerk shall immediately notify the County Election Commission and the County Clerk by forwarding to each, a certified copy of this ordinance and the map showing the area to be annexed.

SECTION 3. If at such election a majority of the qualified electors voting in such election shall vote for such annexation, the annexation shall be effective and the territory included within the corporate limits of the City of Monette thirty (30) days following the County Clerk's certification of the election results and recording of the same, along with the description and a map of the annexed area, in the county records, and filing a certified copy thereof with the Secretary of State; or in the event an action is filed with the Circuit Court, on the date the judgment of said Court becomes final. If a majority of the qualified electors voting on the issue at the election vote against the annexation, the annexation ordinance shall be null and void.

SECTION 4. No later than forty-five (45) days prior to the election, the city shall identify all persons who reside within the area proposed to be annexed, and the county clerk shall assist the city in determining the names and addresses of all qualified electors residing within that area.

SECTION 5. The city clerk shall give notice of the election by publication by at least one (1) insertion in some newspaper having a general circulation in the city.

SECTION 6. If the annexation is approved and becomes final, the governing body of the city shall, by ordinance, as soon as practical after the annexation, attach and incorporate such annexed territory to and in one (1) or more wards of the city lying adjacent thereto, and the territory so assigned and attached to a ward shall thereafter be considered and become a part thereof as fully as any other part of the city.

SECTION 7. If the annexation is approved and becomes final, the following services shall be extended to the area within three (3) years:

SERVICE DATE
Police Protection Immediately
Fire Protection Immediately
Weekly Garbage Pickup Immediately
Street Lights Immediately
Mosquito Control Measures Immediately
Animal Control Measures Immediately

FILED

DEC 08 2008

BY CHARLIE DANIELS
SECRETARY OF STATE

SECTION 8. The ballots used at said election on the question of annexation shall be marked as follows:

- FOR annexation of the territory described in Ordinance No. 2008-3.
- AGAINST annexation of the territory described in Ordinance No. 2008-3.

SECTION 7. Emergency Clause. This ordinance being necessary for the immediate preservation of the public peace, health, safety, and welfare, as well as compliance with special election statutes, an emergency is hereby declared to exist and this ordinance shall be effective and in full force and effect from and after its passage and approval.

PASSED: August 11, 2008

APPROVED: Jerry Qualls
Jerry Qualls, Mayor

ATTEST: Vicki Carroll
Vicki Carroll, Recorder

CERTIFICATE

I, Vicki Clerk, City Clerk of the City of Monette, Arkansas, hereby certify that this ordinance was duly passed and approved by a two-thirds vote of the total number of members the City Council of the City of Monette, Arkansas, on the 11th day of August, 2008.

Seal
Vicki Carroll
City Clerk
City of Monette, Arkansas

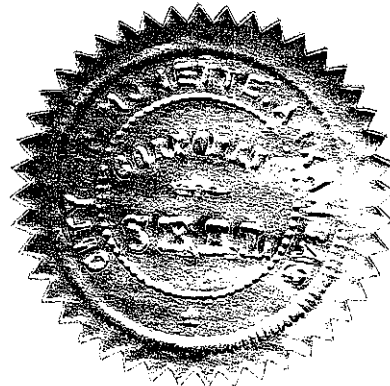

EX-100

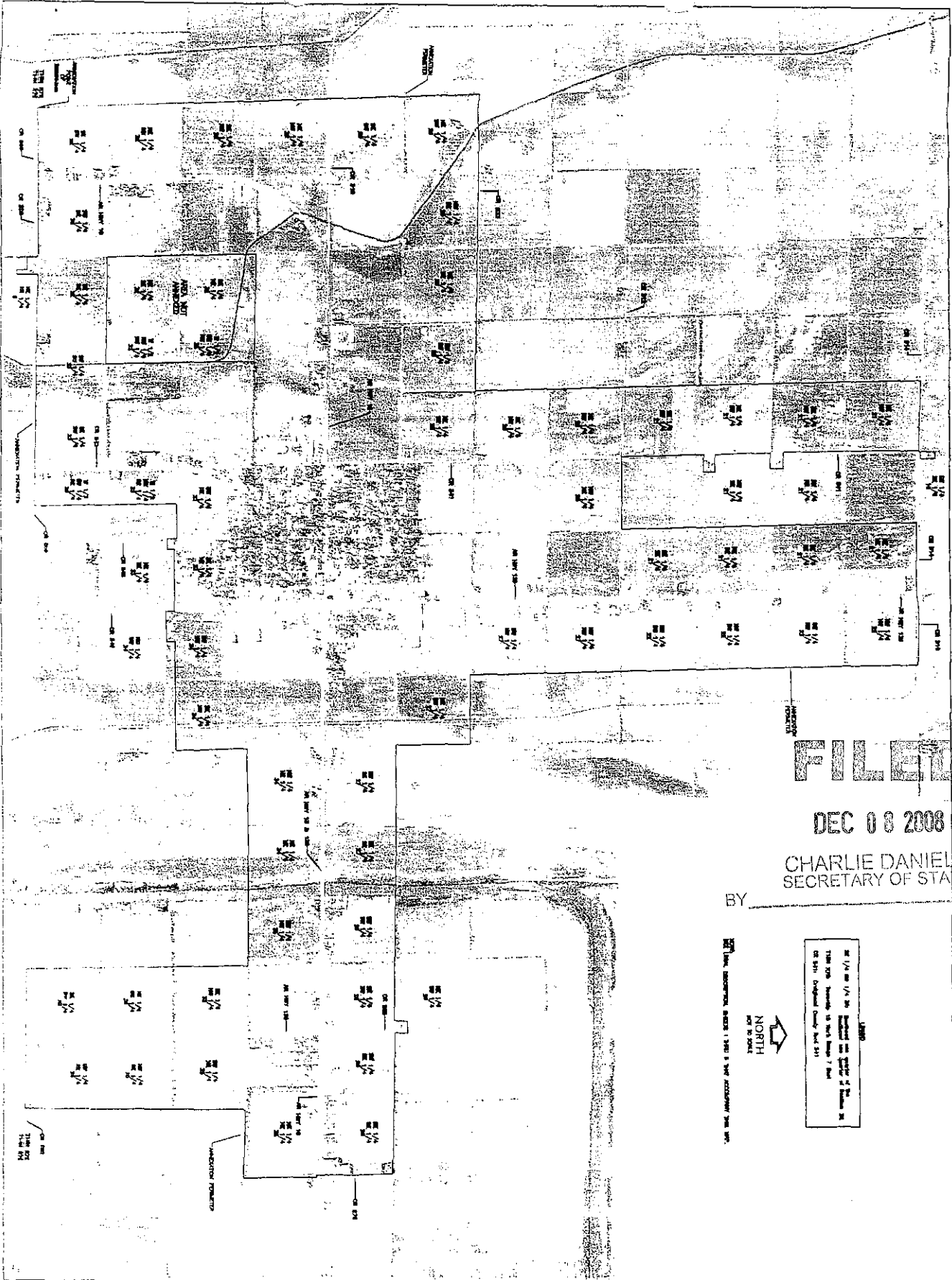

FILED

DEC 08 2008

CHARLIE DANIELS
SECRETARY OF STATE

BY

FOR FURTHER INFORMATION CONTACT THE ENGINEER

NORTH
↑

THIS MAP IS THE PROPERTY OF MILLER NEWELL ENGINEERS INC. IT IS TO BE USED ONLY FOR THE PROJECT AND AREA SHOWN HEREON. IT IS NOT TO BE REPRODUCED OR TRANSMITTED IN ANY FORM OR BY ANY MEANS, ELECTRONIC OR MECHANICAL, INCLUDING PHOTOCOPYING, RECORDING, OR BY ANY INFORMATION STORAGE AND RETRIEVAL SYSTEM, WITHOUT THE WRITTEN PERMISSION OF MILLER NEWELL ENGINEERS INC.

1

ANNEXATION MAP
MONETTE ANNEXATION
MONETTE, ARKANSAS

ANNEXATION MAP
MONETTE ANNEXATION
MONETTE, ARKANSAS

Miller Newell Engineers Inc.
510 THIRD STREET NEWPORT, AR 72112
PHONE (870) 523-8531 FAX (870) 523-8433
Miller Newell EMAIL: MNLNENGR@AOL.COM

