

BAS Correction Historic Annex Ordinance 268: City of Murfreesboro
 *for Census only - was already in state map

City: Murfreesboro
 Mayor: Rodney Fagan

Arkansas Code 14-40-101.

Before an entity undertakes an annexation, consolidation, or detachment proceeding under this chapter, the entity shall coordinate with the Arkansas Geographic Information Systems Office for preparation of legal descriptions and digital mapping for the relevant annexation, consolidation, and detachment areas.

The map contained herein, is evidence, the entity has met requirements of Act 914 of 2015

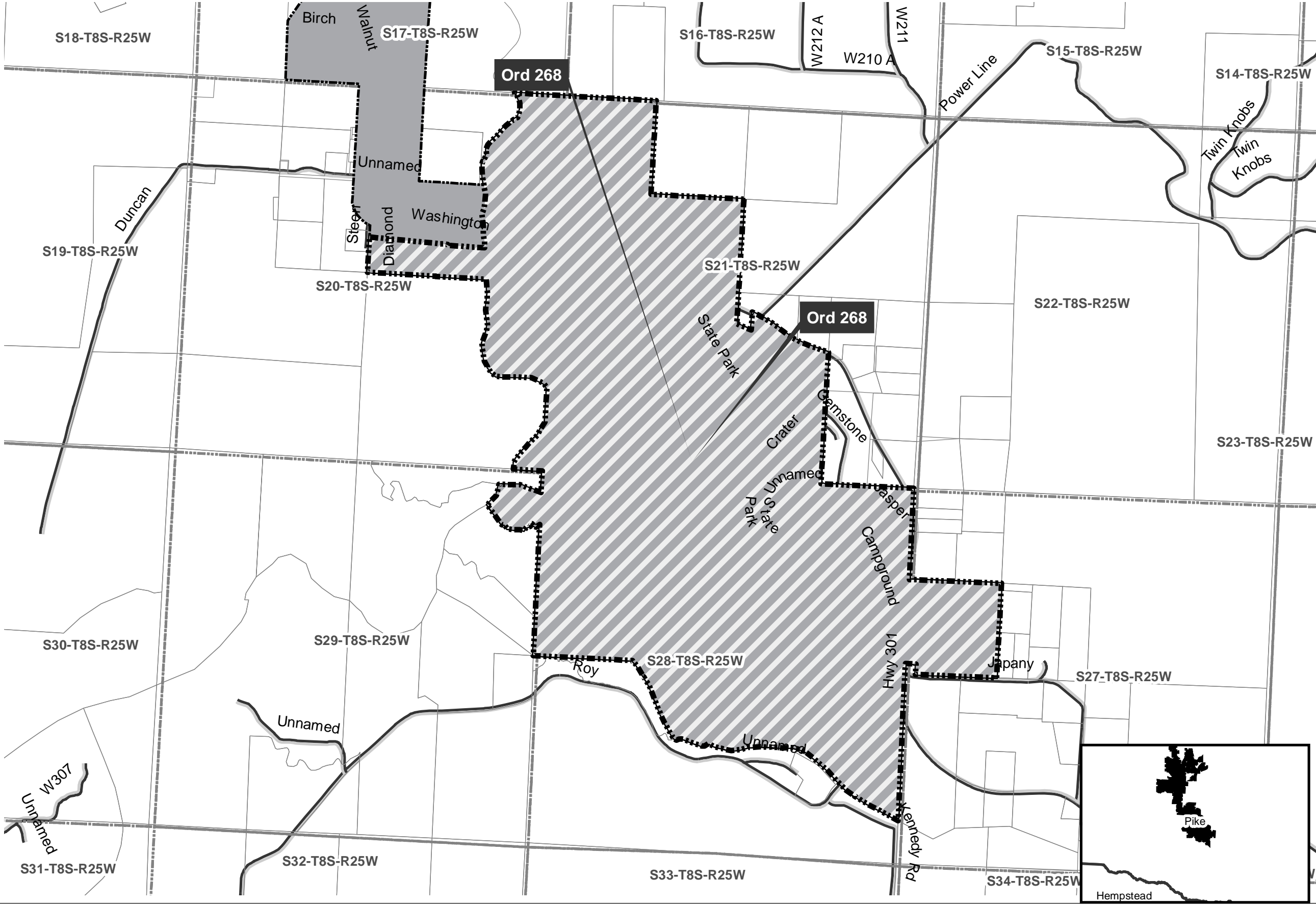

-  Proposed Annex
-  Existing City
-  Sections
-  Parcels
-  Minor Road

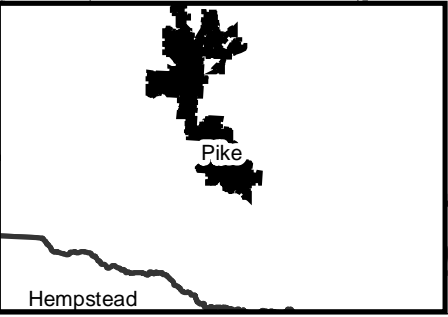
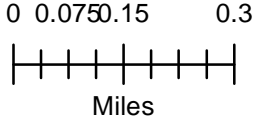

FILED

NOV 12 2010

ORDINANCE NO. 268

CHARLIE DA...
SECRETARY OF STATE

BY _____

AN ORDINANCE ACCEPTING THE ANNEXATION
OF CERTAIN TERRITORY CONTIGUOUS TO
THE CITY OF MURFREESBORO, ARKANSAS, AND
MAKING SAME A PART OF THE CITY OF
MURFREESBORO, ARKANSAS, AND ASSIGNING
SAME TO WARDS

STATE OF ARKANSAS
COUNTY OF PIKE

I, Sandy Campbell Clerk, do hereby certify
that this is a true and correct copy of the
original Ordinance Pike Co.

Dated 11/9/10

Sandy Campbell Clerk

Benny R. Lamb D.C.

DECREE OF ANNEXATION

WHEREAS, Petition was filed with the County Clerk of Pike
County, Arkansas, by the majority of real estate owners in said
territory; that said territory was contiguous and adjoining the
present corporate limits of the City of Murfreesboro, Pike County,
Arkansas; that an accurate plat or map of said territory had been
filed with and made a part of said petition; that proper notice had
been given for the time and in the manner prescribed by law, and that
all things pertaining thereto had been done in the manner prescribed
by law, and that said lands and territory should be annexed to and
made a part of the City of Murfreesboro, Pike County, Arkansas,
subject to the acceptance of same by the City Council of said City
at the proper time as provided by law; and

WHEREAS, the time fixed by law for appealing from said order
of annexation made by the County Court has expired and no appeal has
been taken from said order.

SANDY CAMPBELL
PIKE COUNTY CLERK

NOV 09 2010

FILED
TIME _____

NOW, THEREFORE, BE IT ORDAINED BY THE CITY COUNCIL OF THE CITY OF MURFREESBORO, PIKE COUNTY, ARKANSAS:

SECTION 1. That the following described lands and territory contiguous and adjoining the City of Murfreesboro, Arkansas, be and the same is hereby accepted as part of and annexed to and made a part of the City of Murfreesboro, Arkansas:

See Exhibit "A" attached hereto.

SECTION 2. That the above-described territory shall be annexed to and made a part of Ward West of the City of Murfreesboro, and the same shall henceforth be a part of the said ward as fully as existing parts of said ward.

Passed and approved this 8th day of November, 2010.

APPROVED:

MAYOR

ATTEST:

CLERK OR RECORDER

FILED
NOV 12 2010
CHARLIE DANIELS
SECRETARY OF STATE
BY _____

EXHIBIT "A"

Part of the Southeast Quarter of Section 28, Township 8 South, Range 25 West, Pike County, Arkansas, more particularly described as follows:

Starting at the Northeast Corner of Section 28; thence South 6° 12' East along the East line thereof a distance of 2845.73 feet to a point on the proposed centerline of County Road #6; thence South 18° 04' West along said proposed centerline a distance of 1129.5 feet to a point; thence in a Southwesterly direction along said proposed centerline on a curve right having a radius of 572.96 feet a distance of 126.7 feet to a point; thence South 30° 44' West along said proposed centerline a distance of 275.0 feet to a point on the proposed Northwesterly right of way line of said County Road; thence North 33° 35' 45" East along said proposed right of way line a distance of 82.1 feet to a point; thence North 30° 44' East along said proposed right of way line a distance of 100.0 feet to a point; thence North 47° 26' East along said proposed right of way line a distance of 104.4 feet to a point; thence South 59° 16' East a distance of 35.0 feet to the point of beginning and containing 0.385 acre more or less.

AND ALSO:

TRACT 1: All that part of the E/2 of Section 20 lying East of Prairie Creek, containing 90 acres, more or less;

The NW/4 of NW/4 of Section 21, containing 40 acres, more or less;

The South half of NW/4 of Section 21, Containing 80 acres, more or less;

The SW/4 of Section 21, containing 160 acres, more or less;

The SW/4 of NW/4 of Section 27, except one-half acre in the Southwest corner thereof, containing 39 ½ acres, more or less;

All that part of Section 28 lying north and east of the Little Missouri River, containing 353.53 acres, more or less;

All that part of the W/2 of Section 28 lying South of

FILED

NOV 12 2010

CHARLIE DANIELS
SECRETARY OF STATE

BY _____

the Little Missouri River and North of Duncan Slough, containing 60 acres, more or less; and

All that part of the NE/4 of NE/4 of Section 29 bounded on the North, East and West by the Little Missouri River, and on the South by a certain slough dividing said land from the McBrayer land sold to Stewart, containing 5 acres, more or less;

All in Township 8 South, Range 25 West, and containing in the aggregate 828.03 acres, more or less,

Together with all the buildings, machinery, tangible personal property, and improvements of whatsoever kind or character in, on and about said lands.

TRACT 2: The SW/4 of SE/4, Section 21, Township 8 South, Range 25 West, LESS AND EXCEPT Tract 3 below.

TRACT 3: Beginning at the Northwest Corner of SW/4 of SE/4 run thence South along the west line thereof 913 feet; thence East 1 foot; thence North 913 feet to the North line of the said SW/4 of SE/4; thence West 1 foot to the point of beginning; ALSO;

Commencing at the Northwest corner of the SW/4 of SE/4; run thence South 1268 feet to the point of beginning; run thence East 1 foot; run thence South 52 feet; run thence West 1 foot; run thence North 52 feet to the point of beginning;

All in Township 8 South, Range 25 West.

Tracts 2 and 3 containing 9.25 acres and 30 acres each more or less.

AND ALSO:

FILED

NOV 12 2010

Beginning at the Southwest Corner of the NW $\frac{1}{4}$, SE $\frac{1}{4}$, Section 21 and run thence N 03°20" E. for 874.43 feet; Thence S. 67°25'00" E. for 210.00; Thence N. 03°03'20" E. for 252.38 feet to the centerline of Arkansas State Highway #301; Thence run S. 67° 25' 00" E. for 95.82 feet; Thence run along curve to the right for a distance of 247.78 feet; Thence S. 52°33'00" E. for

CHARLIE DANIELS
SECRETARY OF STATE

By of said

201.53 feet; Thence run along curve to the left along said centerline for a distance of 362.14 feet; Thence run S. 70°39'25" E. for 325.48 feet to the east line of said NW ¼ SE ¼ Section 21: Thence run S. 03°29'30" W. for 530.27 feet to the SE corner of said NW ¼ SE ¼ Section 21: Thence run N. 87°56'37" W. for 1309.27 feet to the Point of beginning (P.O.B.), contains in all 23.41 acres and is subject to all easements, public or private, which may exist thereon.

AND ALSO:

Part of the Southwest Quarter of the Southeast Quarter (SW ¼ SE ¼) of Section Twenty-One(21) Township Eight (8) South, Range Twenty-five (25) West, described as follows: Commencing at the Northwest corner of the said forty acre tract; then South 569 feet to the point of beginning; thence East one foot thence South one foot, thence West one foot, thence North one foot to the point of beginning, containing one square foot, more or less.

AND ALSO:

Part of the Southwest Quarter of the Southeast Quarter (SW ¼ SE ¼) of Section 21, Township 8 South, Range 25 West, described as follows: Beginning 563 feet South of the Northwest corner of said 40 acre tract; thence South 50 feet; thence East 1 foot; thence North 50 feet, thence West 1 foot to the point of beginning containing 50 square feet.

AND ALSO:

Part of the southwest quarter of the southeast quarter (SW ¼ SE ¼) of section 21 township 8 south range 25 west; beginning at the northwest corner of said forty; run thence south along the west line thereof 913 feet; thence east 1 foot; thence north 913 feet to the north line of the said SW ¼ of SE ¼; thence west 1 foot to the point of beginning; ALSO

Commencing at the northwest corner of the SW ¼ of SE ¼ run thence south 1268 feet to the point of beginning; run thence east 1 foot; run thence south 52 feet to the point of beginning;

All in Township 8 south, range 25 west.

FILED

NOV 12 2010

CHARLIE DANIELS
SECRETARY OF STATE

BY _____

TOWNSHIP 8S • RANGE 25W

SEE PAGE 22

Copyright © 2008 Marceline Mapping

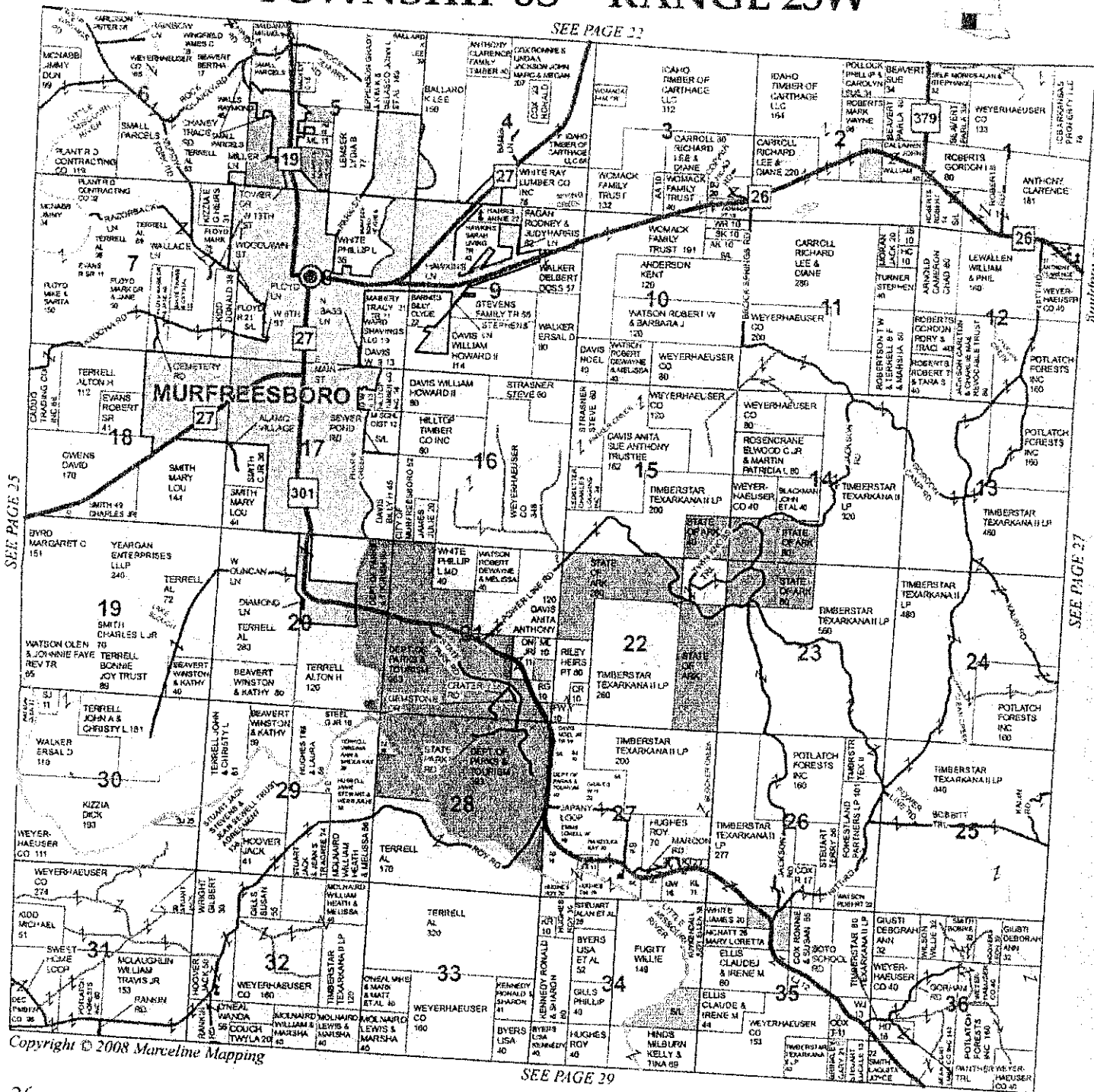

Copyright © 2008 Marceline Mapping

SEE PAGE 29

26

FILED

NOV 12 2010

CHARLIE DANIEL'S
SECRETARY OF STATE

BY _____

STATE OF ARKANSAS
COUNTY OF PIKE

I, Sandy Campbell Clerk, do hereby certify
that this is a true and correct copy of the
original plat map

Dated 11/9/10

Sandy Campbell Clerk

Penny R. James DC

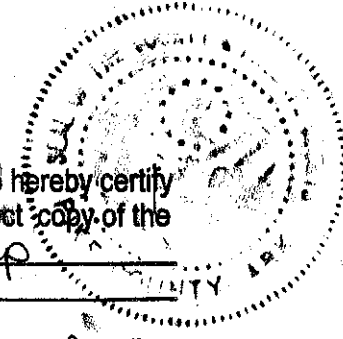



State of Arkansas Secretary of State

Charlie Daniels
Secretary of State

Business & Commercial Services	682-3409
Elections	682-5070
Building & Grounds	682-3407
Communications & Education	683-0057
State Capitol Police	682-5173
Business Office	682-8032
Information Technology	682-3411

November 12, 2010

The Honorable Sandy Campbell
Pike County Clerk
P.O. Box 218
Murfreesboro, Arkansas 71958

Dear Ms. Campbell:

The Following Information has been recorded and filed in the Office of the Secretary of State:

Date: November 12, 2010 County: Pike City: Murfreesboro

Annexation:	Ordinance No: 268
	County Order No.—C-210-1
	Plat x-
	Election -
	Island -
Incorporation:	Ordinance No. -
	Co. Order No. -
	Plat -
	Election -

Census Information: The following City or Town has been upgraded or reduced to:

- 1st Class City -
- 2nd Class City -
- Incorporated Town -

I have forwarded this information to the Arkansas Municipal League and the Arkansas Highway and Transportation Department and the Arkansas State Data Center. If you have any further questions please do not hesitate to contact me at 1-800-482-1127 or 682-3451

Sincerely,

Pam Ratliff
Election Services Representative
Arkansas Secretary of State

FILED

NOV 12 2010

CHARLIE DANIELS
SECRETARY OF STATE

BY _____

IN THE CIRCUIT COURT OF PIKE COUNTY, ARKANSAS
CIVIL DIVISION

IN THE MATTER OF ANNEXING
TO THE CITY OF MURFREESBORO, ARKANSAS
CERTAIN TERRITORY CONTIGUOUS
THE SAID CITY OF MURFREESBORO, ARKANSAS

CASE NO. C-2010-1

DECREE OF ANNEXATION

On this regular day of a regular term of the County Court of Pike County, Arkansas, there is presented to this Court by Penny Lamb, agent(s) of the Petitioners, a petition for annexation of certain territory, hereinafter more particularly described, to the City of Murfreesboro, Arkansas, and the Court being fully advised of the facts and the law, doth hereby find, judge and decree as follows:

The Court finds that the petition was filed more than thirty(30) days prior to this date and that in said Petition the said Penny Lamb was selected by the Petitioners to act on their behalf in filing and presenting the Petition.

The Court doth find that a majority of the total number of real estate owners in the area affected by this Petition have signed said petition and that such majority owns more than one-half (1/2) of the acreage affected.

SANDY CAMPBELL
PIKE COUNTY CLERK

SEP 20 2010

FILED
TIME _____

STATE OF ARKANSAS
COUNTY OF PIKE

I, Sandy Campbell Clerk, do hereby certify that this is a true and correct copy of the original Decree of Annexation

Dated 11/9/10
Sandy Campbell Clerk

Penny R. Lamb
COUNTY CLERK

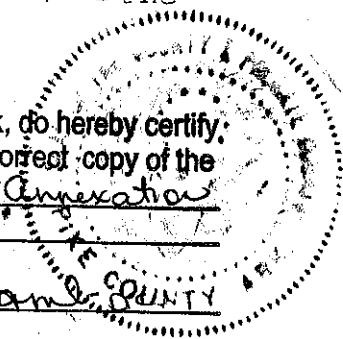

FILED

NOV 12 2010

CHARLIE DANIELS
SECRETARY OF STATE

The court further finds that the territory sought to be annexed was accurately described in said Petition and that said territory is contiguous to the boundaries of the City of Murfreesboro, Arkansas.

The Court further finds that attached to and made a part of said petition is an accurate map of the territory sought to be annexed to the city of Murfreesboro, Arkansas.

The Court further finds that the prayer of the petition is right and proper.

Therefore, the Court doth hereby ORDER, JUDGE and DECREE that the following described territory be and the same is hereby annexed to and made part of the City of Murfreesboro, Pike County, Arkansas to-wit:

The Court doth further order that the original papers in this cause be delivered to the Clerk of Pike County, Arkansas same to be property recorded upon the records of Pike County, Arkansas, and the Clerk, after properly recording and filing the original PAPERS, prepare transcripts of the same; that one of the certified transcripts be delivered to the City of Murfreesboro, Pike County, Arkansas, one copy to the Secretary of State and one copy to the

Director of the Tax Division of the Arkansas Public Service
Commission.

PIKE COUNTY JUDGE

FILED

NOV 12 2010

CHARLIE DANIELS
SECRETARY OF STATE

BY _____

EXHIBIT "A"

Part of the Southwest Quarter of the Southeast Quarter (SW $\frac{1}{4}$ SE $\frac{1}{4}$) of Section Twenty-One(21) Township Eight (8) South, Range Twenty-five (25) West, described as follows: Commencing at the Northwest corner of the said forty acre tract; then South 569 feet to the point of beginning; thence East one foot thence South one foot, thence West one foot, thence North one foot to the point of beginning, containing one square foot, more or less.

FILED

NOV 12 2010

CHARLIE DANIELS
SECRETARY OF STATE

BY _____

EXHIBIT "A"

Beginning at the Southwest Corner of the NW $\frac{1}{4}$, SE $\frac{1}{4}$, of said Section 21 and run thence N 03°20" E. for 874.43 feet; Thence S. 67°25'00" E. for 210.00; Thence N. 03°03'20" E. for 252.38 feet to the centerline of Arkansas State Highway #301; Thence run S. 67° 25' 00" E. for 95.82 feet; Thence run along curve to the right for a distance of 247.78 feet; Thence S. 52°33'00" E. for 201.53 feet; Thence run along curve to the left along said centerline for a distance of 362.14 feet; Thence run S. 70°39'25" E. for 325.48 feet to the east line of said NW $\frac{1}{4}$ SE $\frac{1}{4}$ Section 21: Thence run S. 03°29'30" W. for 530.27 feet to the SE corner of said NW $\frac{1}{4}$ SE $\frac{1}{4}$ Section 21: Thence run N. 87°56'37" W. for 1309.27 feet to the Point of beginning (P.O.B.), contains in all 23.41 acres and is subject to all easements, public or private, which may exist thereon.

FILED

NOV 12 2010

CHARLIE DANIELS
SECRETARY OF STATE

BY _____

EXHIBIT "A"

Part of the Southeast Quarter of Section 28, Township 8 South, Range 25 West, Pike County, Arkansas, more particularly described as follows:

Starting at the Northeast Corner of Section 28; thence South 6° 12' East along the East line thereof a distance of 2845.73 feet to a point on the proposed centerline of County Road #6; thence South 18° 04' West along said proposed centerline a distance 1129.5 feet to a point; thence in a Southwesterly direction along said proposed centerline on a curve right having a radius of 572.96 feet a distance of 126.7 feet to a point; thence South 30° 44' West along said proposed centerline a distance of 275.0 feet to a point on the proposed Northwesterly right of way line of said County Road; thence North 33° 35' 45" East along said proposed right of way line a distance of 82.1 feet to a point; thence North 30° 44' East along said proposed right of way line a distance of 100.0 feet to a point; thence North 47° 26' East along said proposed right of way line a distance of 104.4 feet to a point; thence South 59° 16' East a distance of 35.0 feet to the point of beginning and containing 0.385 acre more or less.

FILED

NOV 12 2010

CHARLIE DANIELS
SECRETARY OF STATE

BY _____

FILED

EXHIBIT "A"

NOV 12 2010

TRACT 1: All that part of the E/2 of Section 20 lying
Prairie Creek, containing 90 acres, ~~more or less;~~ more or less;

CHARLIE DANIELS
SECRETARY OF STATE

The NW/4 of NW/4 of Section 21, containing 40 acres,
more or less;

The South half of NW/4 of Section 21, Containing 80
acres, more or less;

The SW/4 of Section 21, containing 160 acres, more or
less;

The SW/4 of NW/4 of Section 27, except one-half acre
in the Southwest corner thereof, containing 39 ½
acres, more or less;

All that part of Section 28 lying north and east of
the Little Missouri River, containing 353.53 acres,
more or less;

All that part of the W/2 of Section 28 lying South of
the Little Missouri River and North of Duncan Slough,
containing 60 acres, more or less; and

All that part of the NE/4 of NE/4 of Section 29
bounded on the North, East and West by the Little
Missouri River, and on the South by a certain slough
dividing said land from the McBrayer land sold to
Stewart, containing 5 acres, more or less;

All in Township 8 South, Range 25 West, and containing
in the aggregate 828.03 acres, more or less,

Together with all the buildings, machinery, tangible
personal property, and improvements of whatsoever kind
or character in, on and about said lands.

TRACT 2: The SW/4 of SE/4, Section 21, Township 8 South, Range
25 West, LESS AND EXCEPT Tract 3 below.

TRACT 3: Beginning at the Northwest Corner of SW/4 of SE/4 run
thence South along the west line thereof 913 feet;
thence East 1 foot; thence North 913 feet to the North

line of the said SW/4 of SE/4; thence West 1 foot to the point of beginning; ALSO;

Commencing at the Northwest corner of the SW/4 of SE/4; run thence South 1268 feet to the point of beginning; run thence East 1 foot; run thence South 52 feet; run thence West 1 foot; run thence North 52 feet to the point of beginning;

All in Township 8 South, Range 25 West.

Tracts 2 and 3 containing 9.25 acres and 30 acres each more or less.

FILED

NOV 12 2010

CHARLIE DANIEL S
SECRETARY OF STATE

BY _____

EXHIBIT "A"

Part of the southwest quarter of the southeast quarter (SW $\frac{1}{4}$ SE $\frac{1}{4}$) of section 21 township 8 south range 25 west; beginning at the northwest corner of said forty; run thence south along the west line thereof 913 feet; thence east 1 foot; thence north 913 feet to the north line of the said SW $\frac{1}{4}$ of SE $\frac{1}{4}$; thence west 1 foot to the point of beginning; ALSO

Commencing at the northwest corner of the SW $\frac{1}{4}$ of SE $\frac{1}{4}$ run thence south 1268 feet to the point of beginning; run thence east 1 foot; run thence south 52 feet to the point of beginning;

All in Township 8 south, range 25 west.

FILED

NOV 12 2010

CHARLIE DANIELS
SECRETARY OF STATE

BY _____

EXHIBIT "A"

Part of the Southwest Quarter of the Southeast Quarter (SW $\frac{1}{4}$ SE $\frac{1}{4}$) of Section 21, Township 8 South, Range 25 West, described as follows: Beginning 563 feet South of the Northwest corner of said 40 acre tract; thence South 50 feet; thence East 1 foot; thence North 50 feet, thence West 1 foot to the point of beginning containing 50 square feet.

FILED

NOV 12 2010

CHARLIE DANIELS
SECRETARY OF STATE

BY _____